

Am Vogelbach

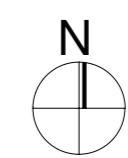

Neubau Einfamilien-Wohnhaus
 Abbruch Bestand

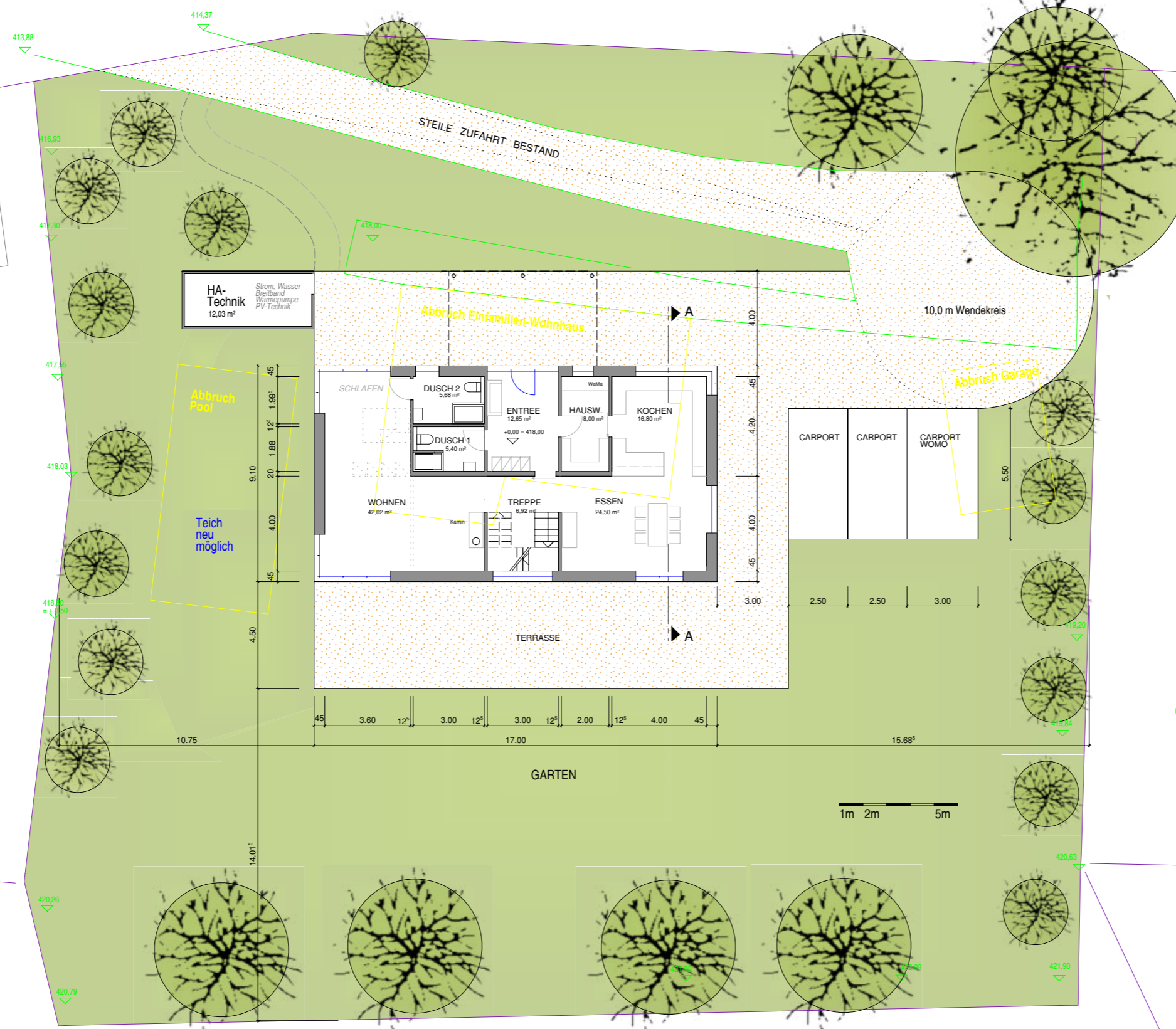
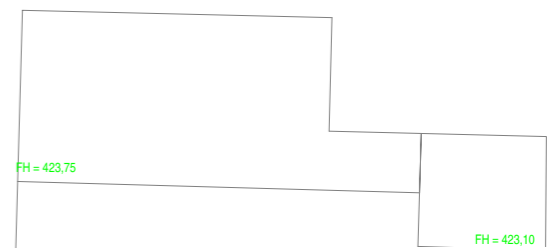

PROJEKT
**NEUBAU 1-FAM.WHS
 WITTNAU
 AM VOGELBACH 2
 FLST.NR. 597/3**

BAUHERR

PLANUNG
**ARCHISOLO BRAUN
 G. BRAUN DIPL.ING.ARCH
 IN DEN BERGEN 46
 79585 STEINEN**

PLAN
GRUNDRISS EG M. 1 : 200
**-VORABZUG-
 BAUVORANFRAGE 15.05.2023**

TH = 420,95

TH = 426,25

FH = 431,00

FH = 425,05