

## Grundriss DG

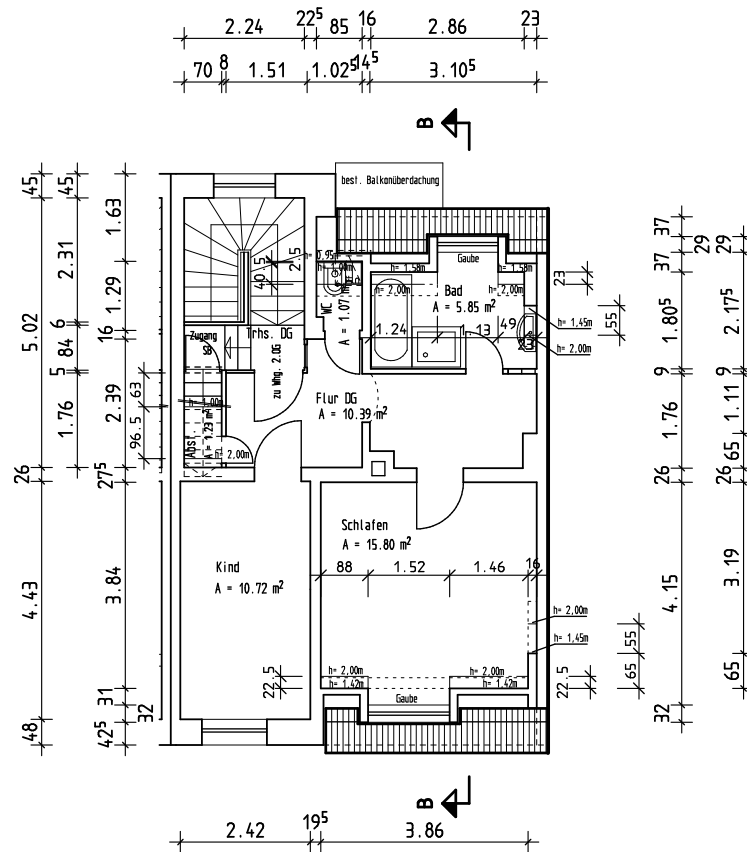

## Wohnfläche Wohnung 3 (DG)

Raumbez.	Fläche	Abzug	Wohnfläche
Kind	A = 10.72 m²		A = 10.72 m²
Schlafen	A = 15.80 m²	$(0.88 \times 0.225 + 1.46 \times 0.225 + 0.55 \times 0.16) \times 0.5 = 0.31$	A = 15.19 m²
Flur DG	A = 10.39 m²		A = 10.39 m²
Bad	A = 5.85 m²	$(1.24 \times 0.23 + 0.49 \times 0.23 + 0.55 \times 0.23) \times 0.5 = 0.26$	A = 5.59 m²
WC	A = 1.07 m²	$0.025 \times 0.85 + 0.405 \times 0.85 \times 0.5 = 0.19$	A = 0.88 m²
Abst.	A = 1.23 m²	$0.63 \times 0.70 + 0.965 \times 0.70 \times 0.5 = 0.78$	A = 0.45 m²
		gesamt:	A = 43.22 m²

## Grundriss DG M 1:100

Anwesen:  
Erlichstraße 61  
96050 Bamberg