

6 M2
5 M2
1 M2
5 M2)

GARC.
WOHNUNG TOP 2:
WOHNUTZFLÄCHE 40.35 M2
GESAMTNUTZFLÄCHE 40.35 M2
(TERRASSE 5.10 M2)

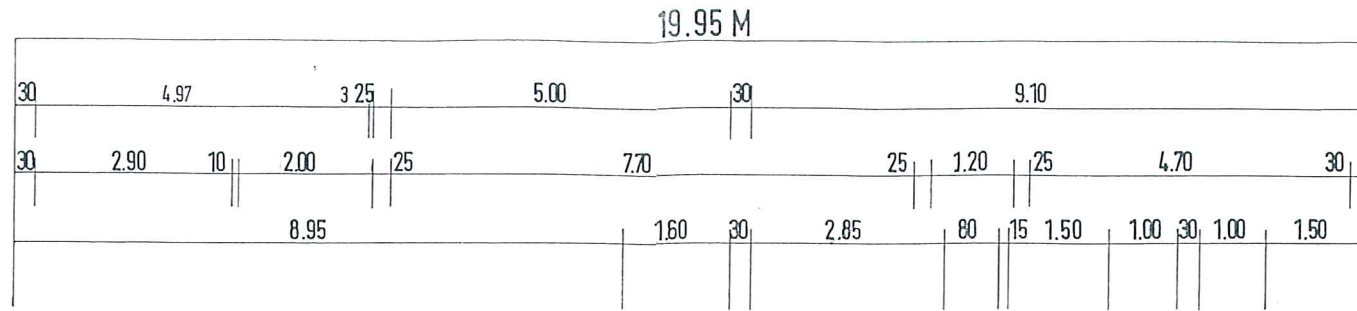

3 ZIMMER
WOHNUNG TOP 3:
WOHNUTZFLÄCHE 77.42 M2
LOGGIAANTEIL 2.55 M2
GESAMTNUTZFLÄCHE 79.97 M2
(TERRASSE 2.55 M2)

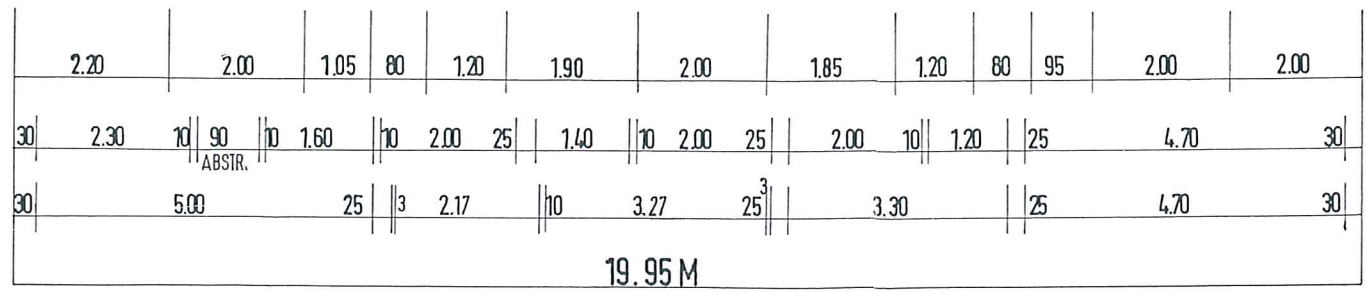
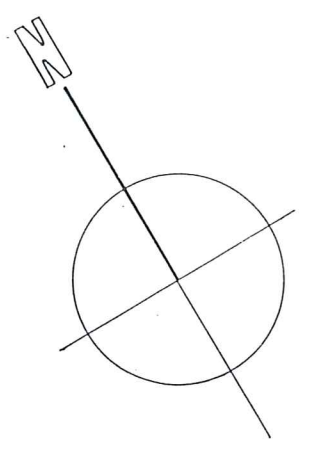
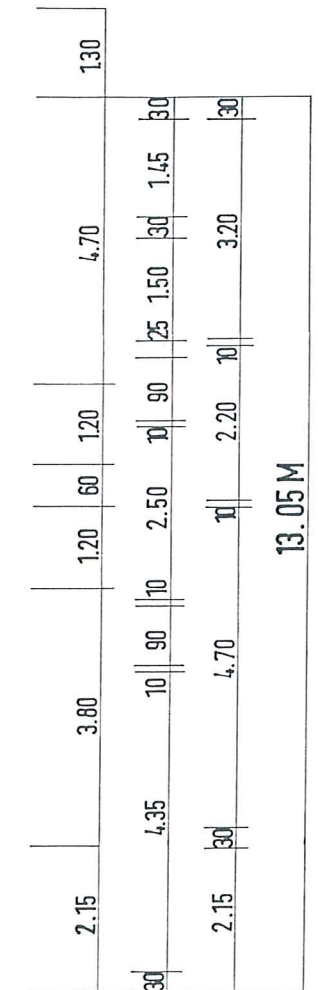
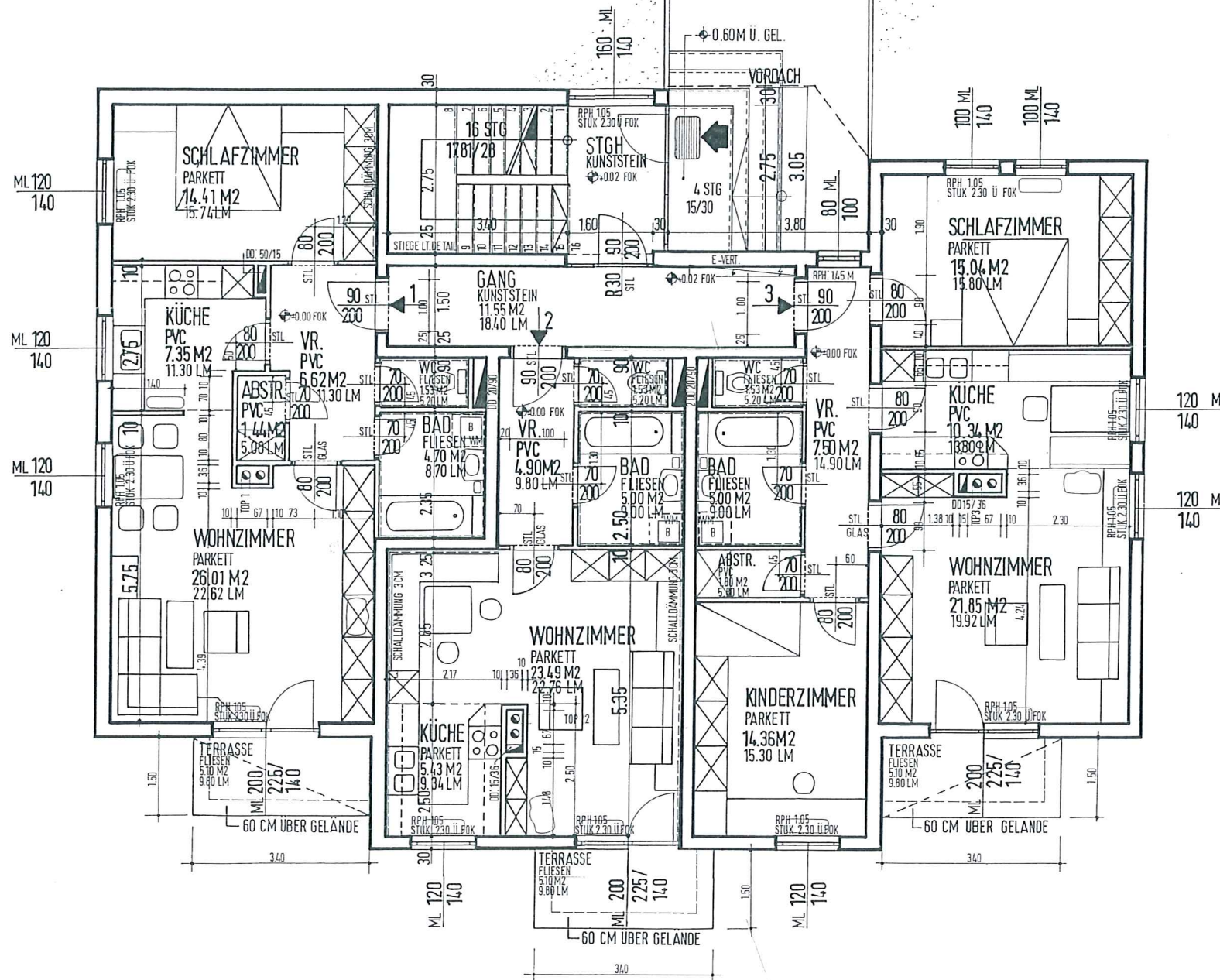
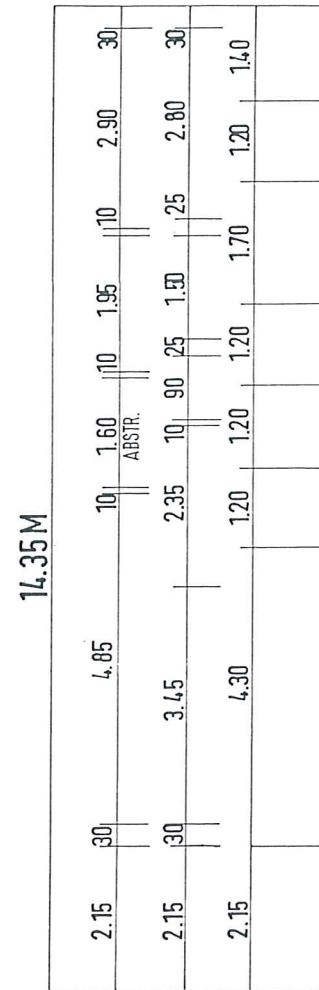

8

FUSSBODENAUFRITT

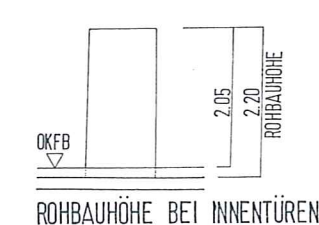

Goldbergstr. 12
Owr.: 150
EG