

Wasserschutzzone III Süd

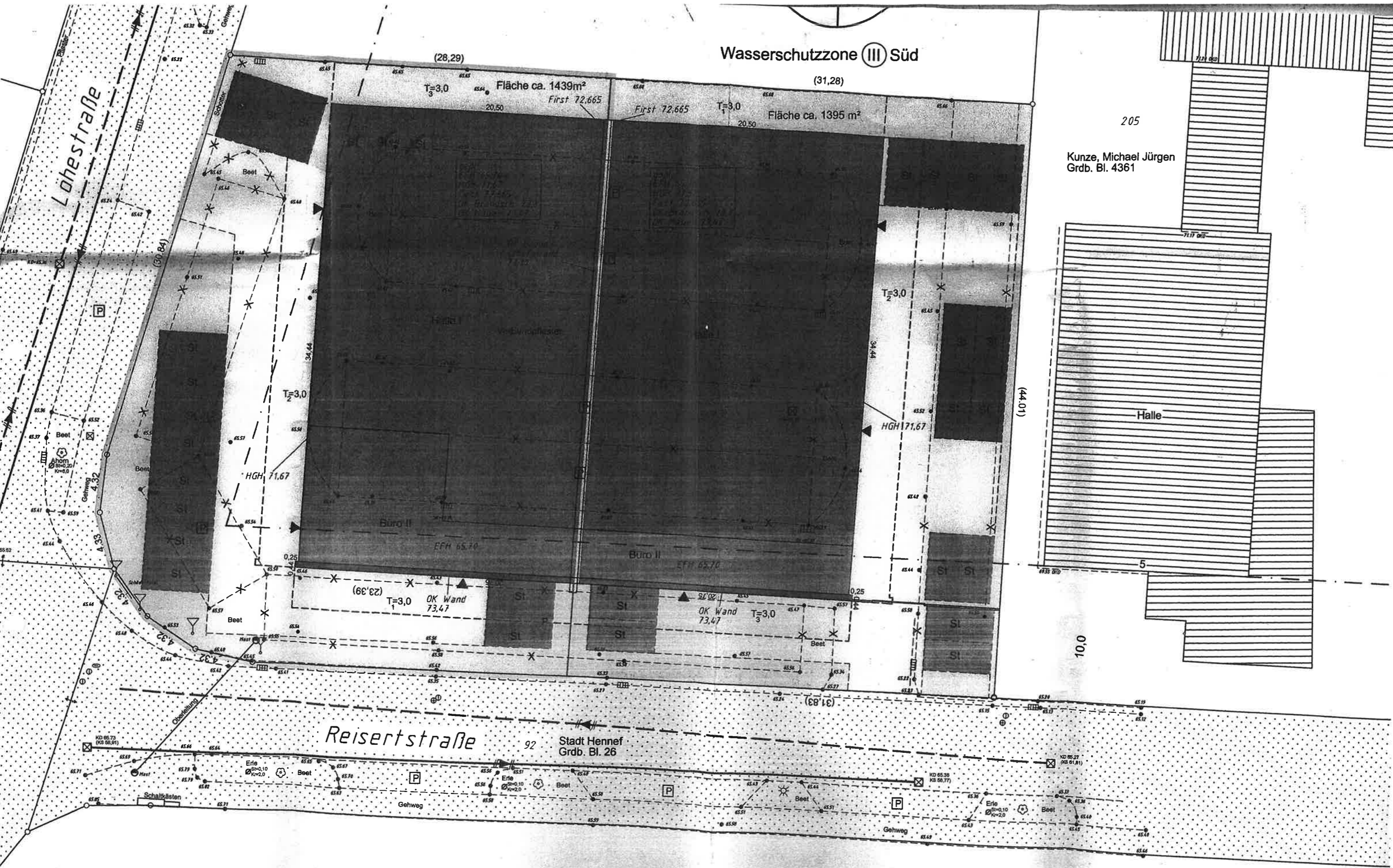

Kunze, Michael Jürgen
Grdb. Bl. 4361

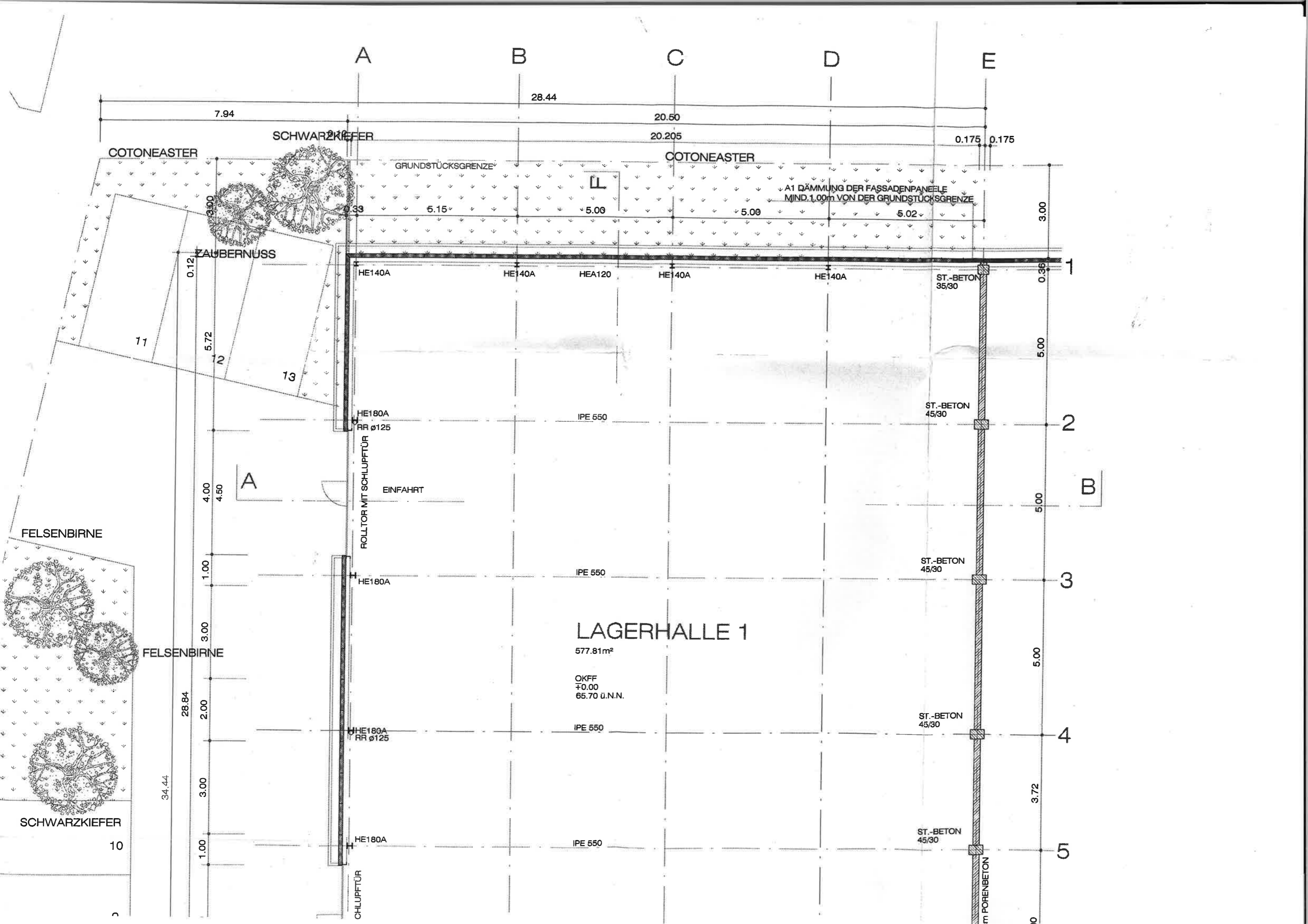

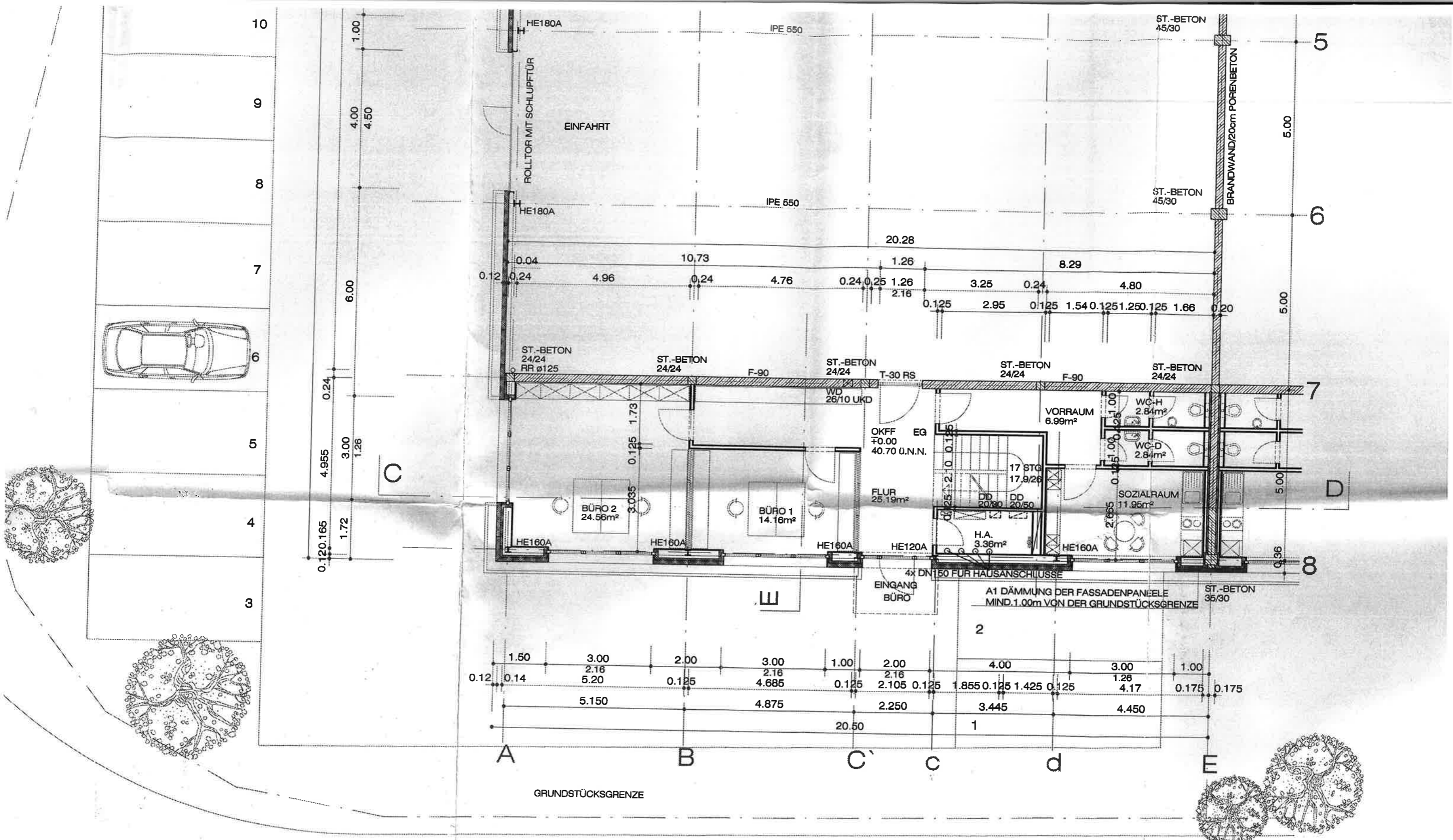

ERDGESCHOSS

REISERTSTRASSE

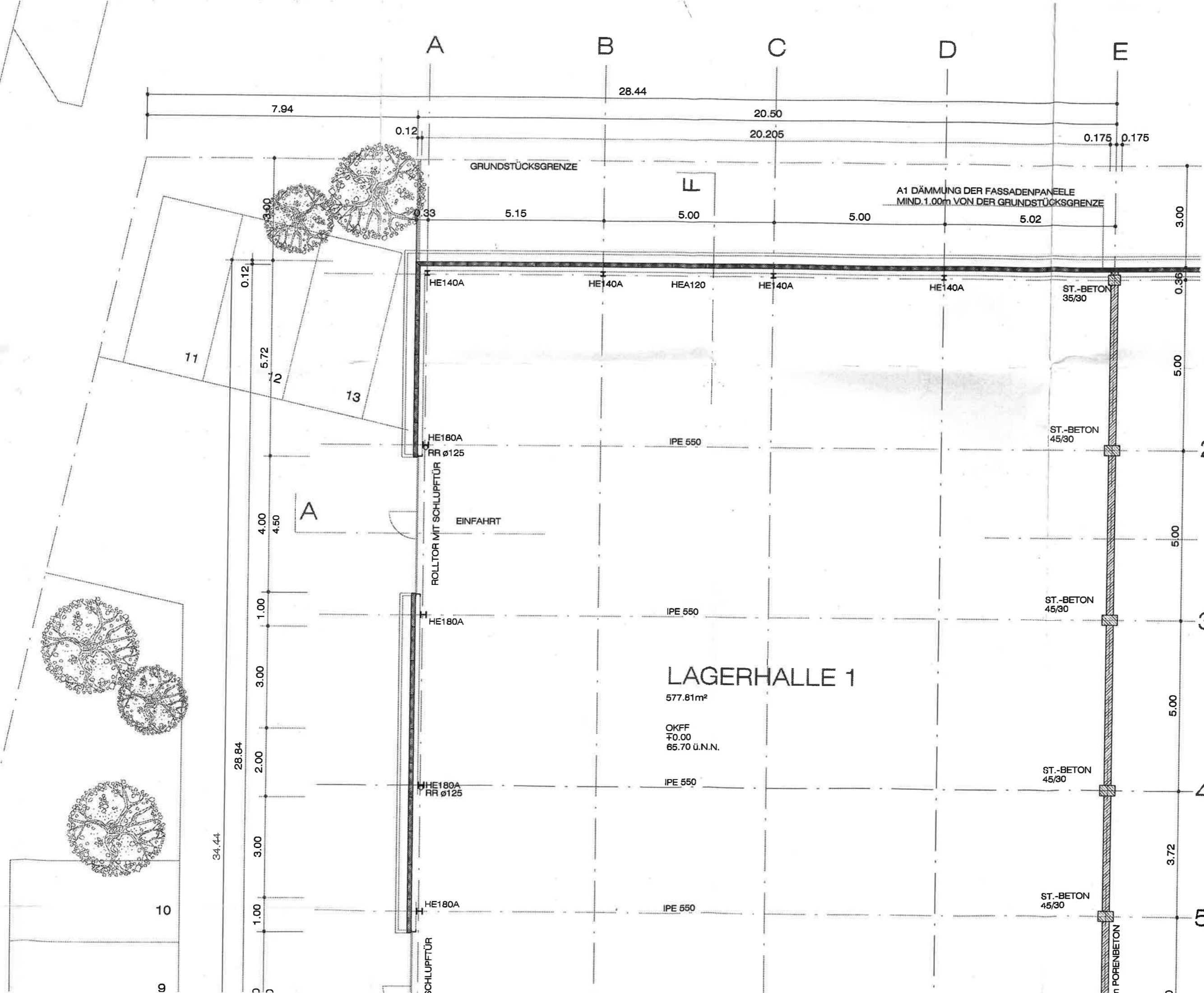
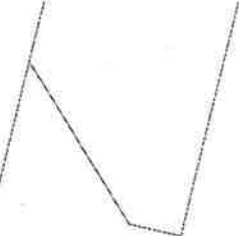

A B C D E

7.94 28.44 20.50 20.205 0.175 0.175

GRUNDSTÜCKSGRENZE

A1 DÄMMUNG DER FASSADENPANEELLE
MIND. 1.00m VON DER GRUNDSTÜCKSGRENZE

HE140A HE140A HEA120 HE140A HE140A

ST.-BETON
35/30

11

12

13

HE180A IPE 550

ST.-BETON
45/30

2

A

ROLLTOR MIT SCHLUPFTÜR
EINFAHRT

B

HE180A IPE 550

ST.-BETON
45/30

3

LAGERHALLE 1

577.81m²

OKFF
±0.00
65.70 Ü.N.N.

HE180A IPE 550

ST.-BETON
45/30

4

34.44

3.00

HE180A IPE 550

ST.-BETON
45/30

5

10

1.00

9

0

SCHLUPFTÜR

PORENBETON

0

LICHTKUPPEL

ST.-BETON
45/30

BRANDWAND/20cm PORENBETON

20.28
 10.73
 4.96
 0.24
 0.04
 0.12
 4.76
 0.24
 0.25
 1.26
 2.16
 3.25
 0.24
 4.80
 8.29
 0.125
 2.95
 0.125
 1.54
 0.125
 1.25
 0.125
 1.66
 0.20

ST.-BETON 24/24 RR ø125
 ST.-BETON 24/24
 F-90
 ST.-BETON 24/24
 ST.-BETON 24/24
 F-90
 ST.-BETON 24/24

OKFF OG
+3.05
43.75 Ü.N.N.

7 STG.
17.94/28

BÜRO 2
23.99m²

BÜRO 1
13.85m²

FLUR
18.46m²

HEIZUNG
3.67m²

BESPRECHUNG
25.53m²

A1 DÄMMUNG DER FASSADENPANEELE
MIND.1.00m VON DER GRUNDSTÜCKSGRENZE

ST.-BETON
35/30

6.50
 3.00
 1.00
 2.00
 4.00
 3.00
 1.00
 0.12
 0.14
 5.175
 0.125
 1.26
 4.71
 0.125
 2.105
 0.125
 2.95
 0.125
 4.555
 0.175
 0.175
 5.150
 4.875
 2.250
 3.445
 4.450
 0.07
 20.50

GRUNDSTÜCKSGRENZE

OBERGESCHOSS

REISERTSTRASSE

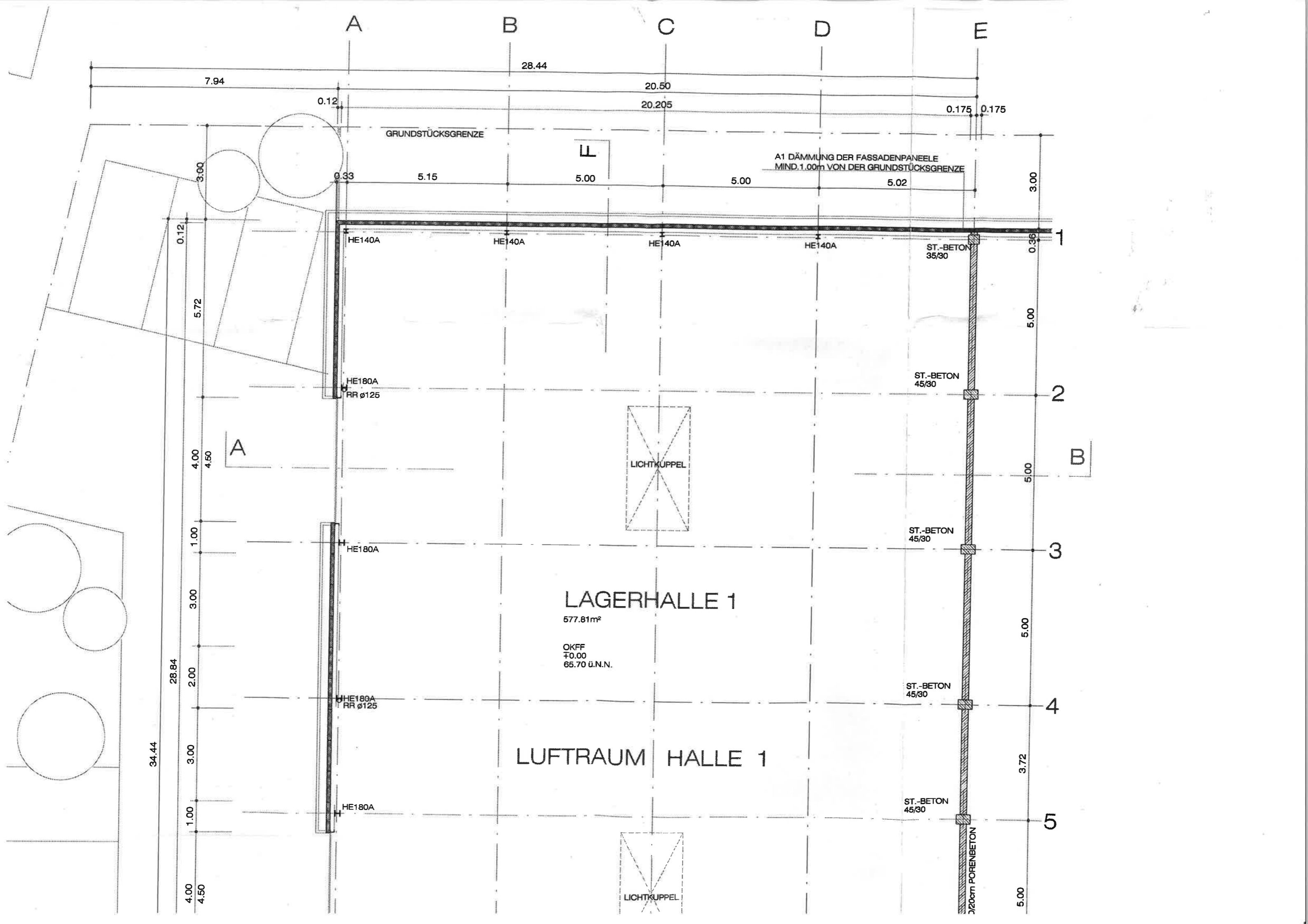

A B C D E

7.94 28.44 20.50 20.205 0.175 0.175

GRUNDSTÜCKSGRENZE

A1 DÄMMUNG DER FASSADENPANEELE
MIND. 1.00m VON DER GRUNDSTÜCKSGRENZE

0.33 5.15 5.00 5.00 5.02 3.00

HE140A HE140A HE140A HE140A ST.-BETON 35/30

HE180A RR ø125 ST.-BETON 45/30

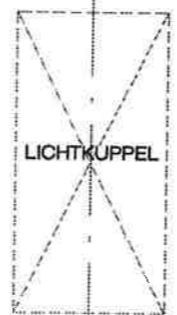

LICHTKUPPEL

ST.-BETON 45/30

LAGERHALLE 1

577.81m²

OKFF
±0.00
65.70 ü.N.N.

ST.-BETON 45/30

LUFTRAUM HALLE 1

HE180A RR ø125

ST.-BETON 45/30

HE180A

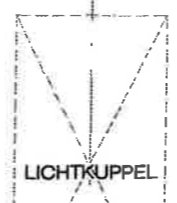

LICHTKUPPEL

20cm PORENBETON

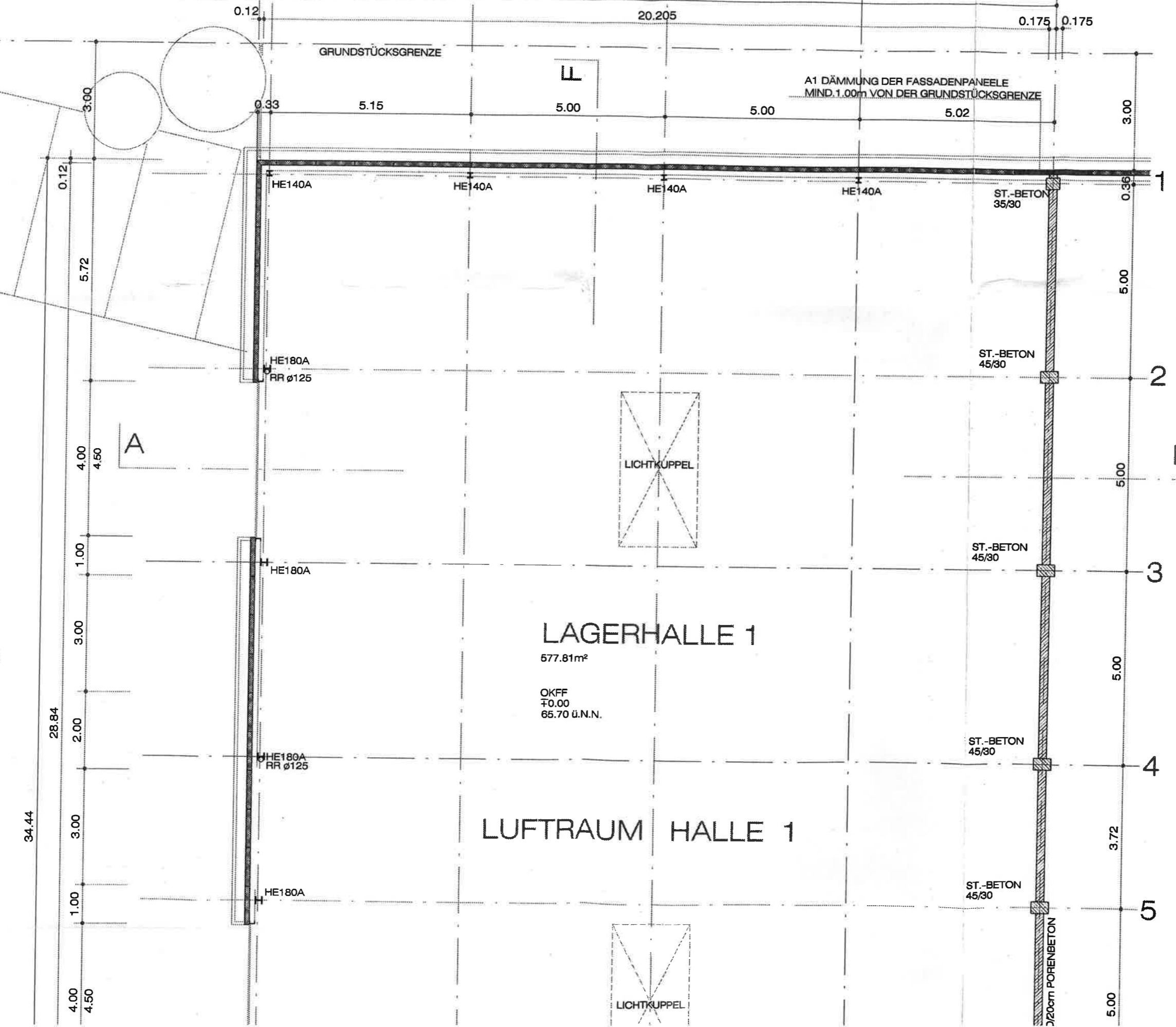

34.44

28.84

3.00

0.12

5.72

4.00
4.50

1.00

3.00

2.00

3.00

1.00

4.00
4.50

0.36

5.00

5.00

5.00

5.00

5.00

5.00

3.72

5.00

A

B

1

2

3

4

5