

**Phase I**

**Phase II (tbc)**

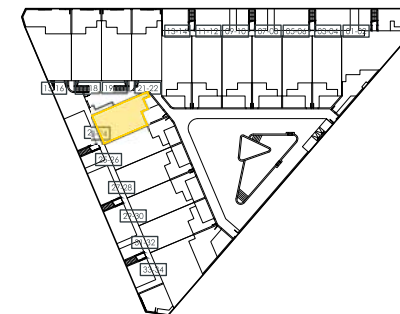

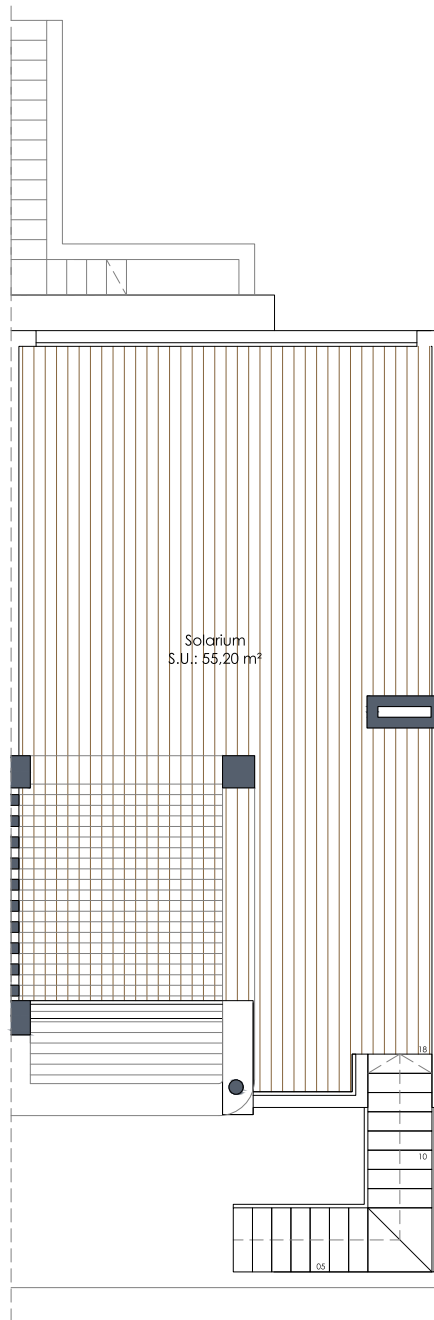
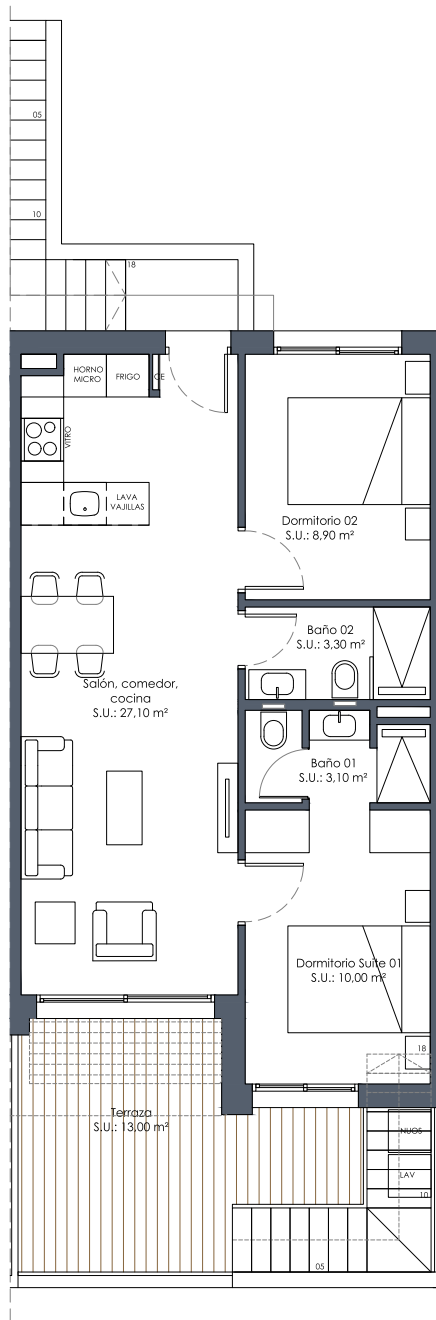

SUPERFICIES VIVIENDA 24	
SUPERFICIE CONSTRUIDA VIVIENDA	63,50 m <sup>2</sup>
SUPERFICIE TERRAZA	13,00 m <sup>2</sup>
SUPERFICIE SOLARIUM	55,20 m <sup>2</sup>

