



Welcome to your
new home

22 detached houses, with a modern and minimalist style. Each villa is built on a plot of land of approximately 350 m² and they have been designed very carefully to provide their inhabitants with peace and comfort, thanks to their large open-plan bright rooms that are perfect to enjoy the outdoors and the surrounding nature.



The sea and the mountains within easy reach.

The town is located 265 metres above sea level, so there are exclusive views to be enjoyed from many points of its geography.

This marvellous town is also a golfers' paradise, because there are numerous top-level golf courses close by.

It is a peaceful place, far from the hustle and bustle of the big cities, with access to all kinds of services and leisure facilities.

Well-being and comfort

All the ancient civilizations have left their mark on this place that grows looking on to the coastline.

It is surrounded by the sea, right under the majestic silhouette of the Puig Campana mountain, next to the charming historical district where the traditional structure of the old houses has been respected. It is the perfect destination for anyone who is looking for a relaxed place to live without having to give up the comforts of having all the services close at hand.

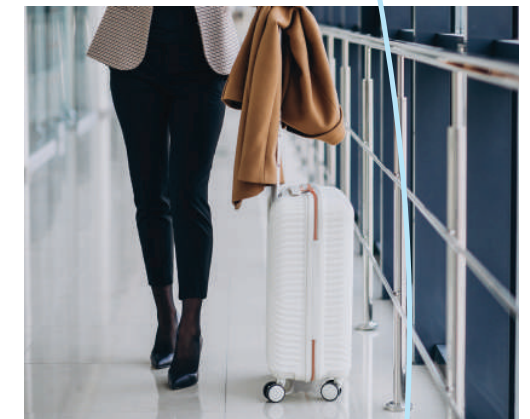

SUPER-MARKETS



NATURE RESERVES AND GOLF COURSES



BEACHES



AMUSEMENT PARKS



AIRPORTS



SHOPPING CENTRES



SCHOOLS



BENIDORM

All the villas have

ENERGY RATING OF THE BUILDING



Plot of land of approximately 350-400 m²

- Large open-plan lounge-dining room-kitchen 46.01 m². (Double height lounge area).
- Fitted kitchen, which includes a kitchen island looking onto the lounge and the swimming pool.
- 3 Full bathrooms (2 en suite).
- 3 Double bedrooms.
- Master bedroom suite with a walk-in closet, private bathroom and direct access onto the first floor.
- Bedroom suite with a built-in wardrobe and a private bathroom, upstairs.
- Double bedroom with a built-in wardrobe, downstairs.
- Large private outdoor areas of almost 300 m². (Porch and private garden, with the option of having a sunken courtyard)**.
- Private swimming pool 7x3 m.
- Parking space on the plot of land, (with the option of having a second parking space, as an extra)**.



Outdoor areas
designed to be
enjoyed





Enjoy the spacious private outdoor areas of the property; its garden with a swimming pool, sunken courtyard and parking area. Their orientation will let you enjoy the Mediterranean sun most of the year, so they will become essential places for your free time and relaxation.

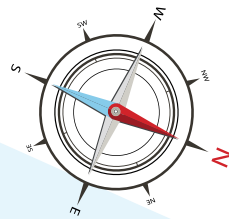
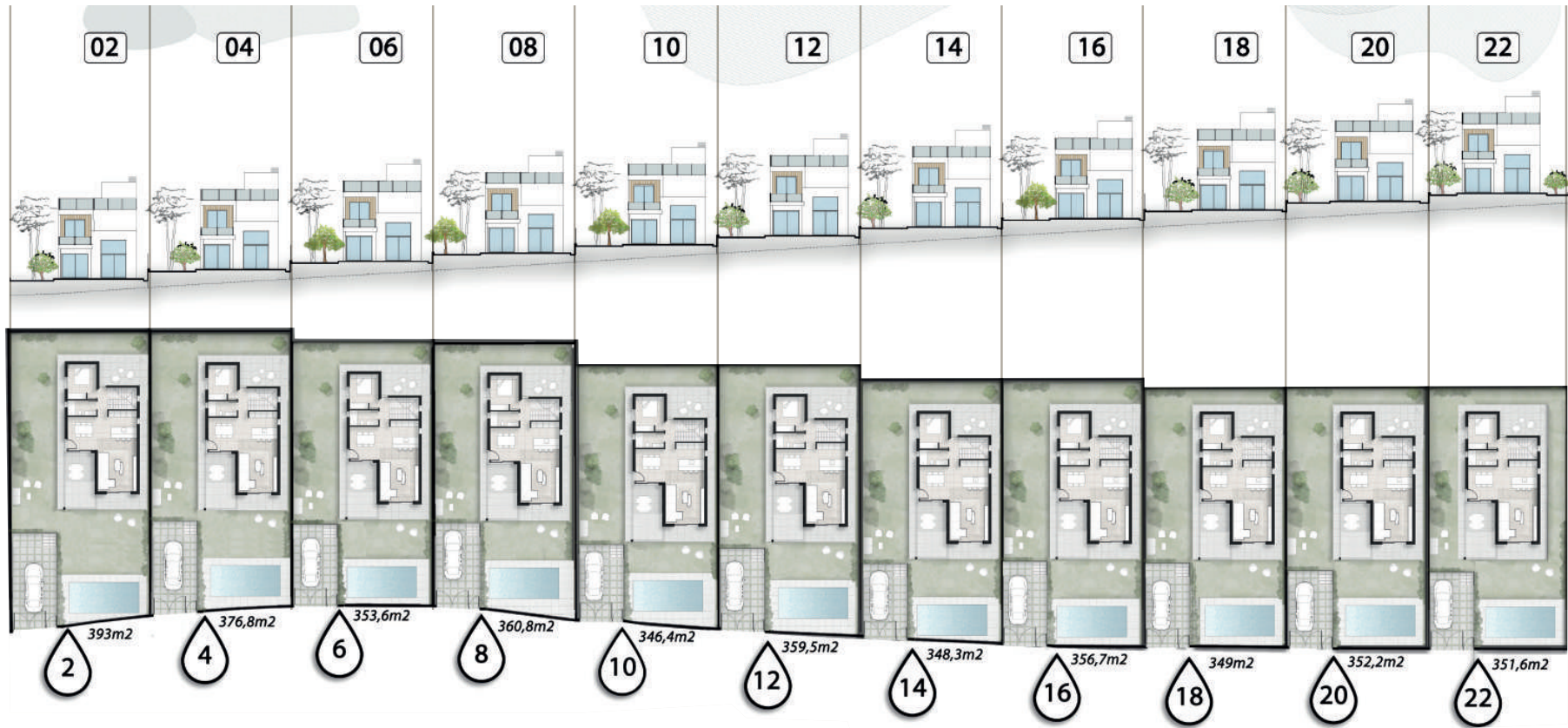

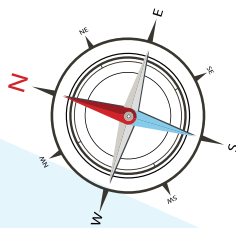
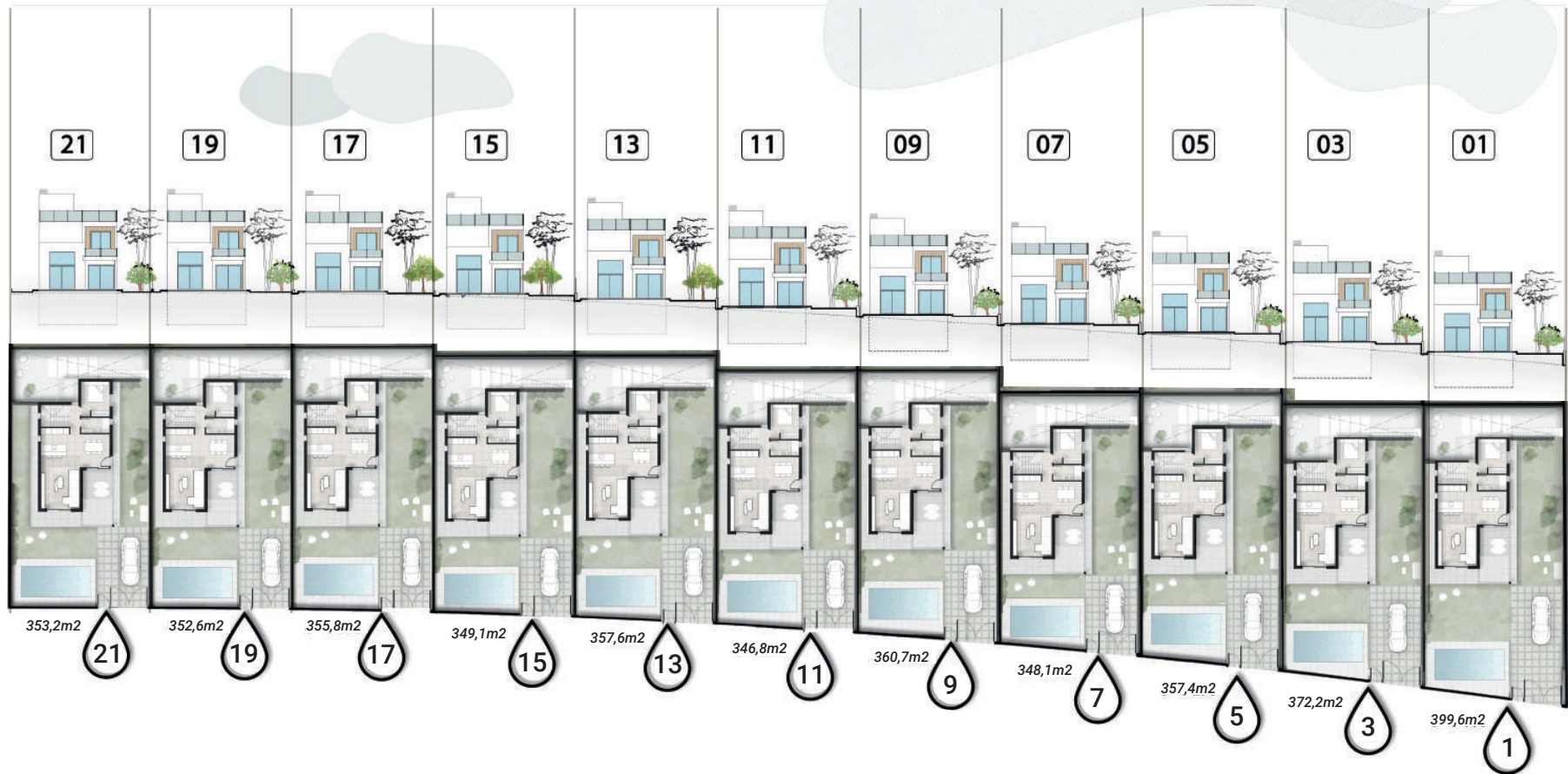

GROSS FLOOR AREA

TOTAL SURFACE AREA

BASEMENT**	92.61 m ²
GROUND FLOOR	78.90 m ²
FIRST FLOOR	48.70 m ²

TOTAL

GROSS FLOOR AREA Odd number houses (with basement)	220.21 m ²
GROSS FLOOR AREA Even number houses (without basement)	127.60 m ²
SIZE OF PLOT OF LAND	Consult m ²

Ground floor



Please note:

This document should be used as a guide only; changes might be made to it as the technical construction project progresses. The villas will be built in line with the building specifications established by the site manager without this affecting the quality. The furniture, gardening and other decorative elements that appear in the plans, except those specifically included in the furnishings, are simply to give you an idea of how you can decorate your house and they do not come with the property.

First floor



Solarium



Please note:

This document should be used as a guide only; changes might be made to it as the technical construction project progresses. The villas will be built in line with the building specifications established by the site manager without this affecting the quality. The furniture, gardening and other decorative elements that appear in the plans, except those specifically included in the furnishings, are simply to give you an idea of how you can decorate your house and they do not come with the property.

Basement



The sunken courtyard, which is fully accessible from the basement and the garden of the house, will fill this area with light and create more space.

Available in the odd number properties and as an extra in the even number properties.

**Basement + sunken courtyard

The villas that come with a basement and the sunken courtyard have lots of advantages, such as the extra space that can be used for recreational activities or for storage. The natural light and the ventilation provided by the sunken courtyard improves the air quality and it adds value to the property.

You can turn this area into the home cinema room, games room, personal gym, wine cellar, office... or whatever you can imagine. This extra space is particularly useful for anyone who is looking for a house that adapts to their changing needs.

Please note:

This document should be used as a guide only; changes might be made to it as the technical construction project progresses. The villas will be built in line with the building specifications established by the site manager without this affecting the quality. The furniture, gardening and other decorative elements that appear in the plans, except those specifically included in the furnishings, are simply to give you an idea of how you can decorate your house and they do not come with the property.

Making your dreams
come true

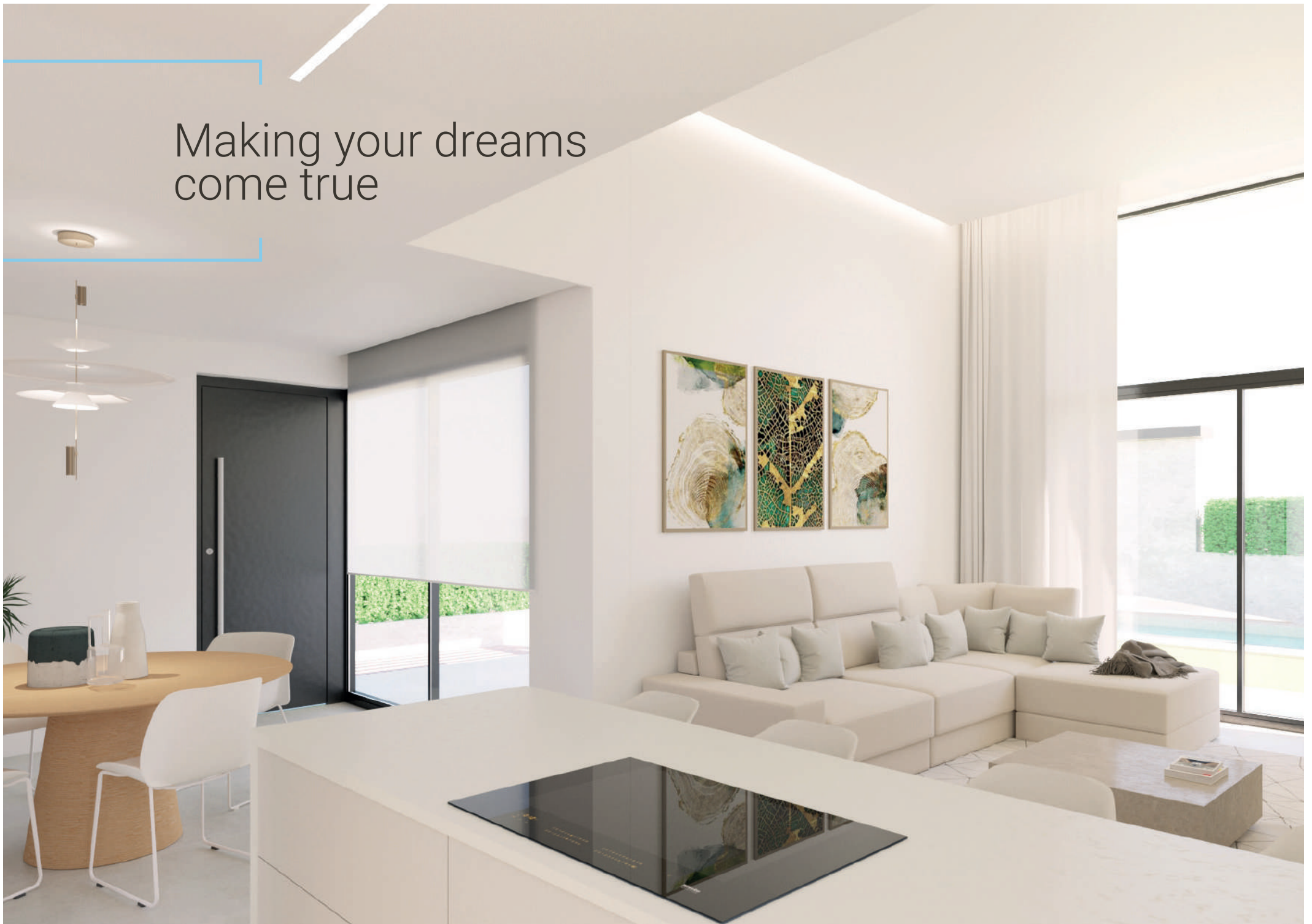





Flooring

Two finishes and one graphic texture designed to convey character. Its stone minerals will give any room strength and style.

Format 90x90, two tones to choose from



ATRIO | LIGHT



ATRIO | LIGHT GREY

Kitchen finishes

Worktop

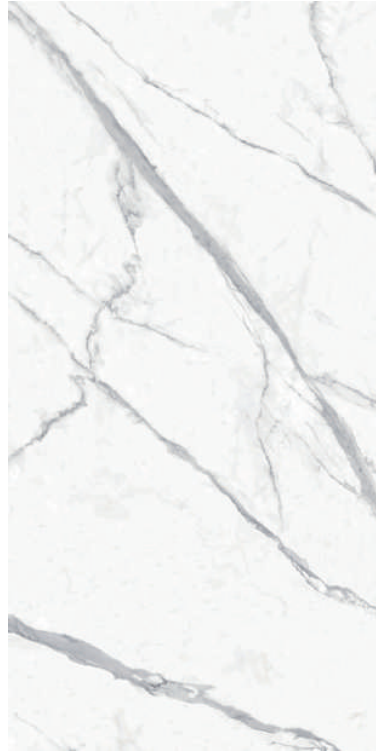

EXTRA STATUARIO



PIETRA GREY

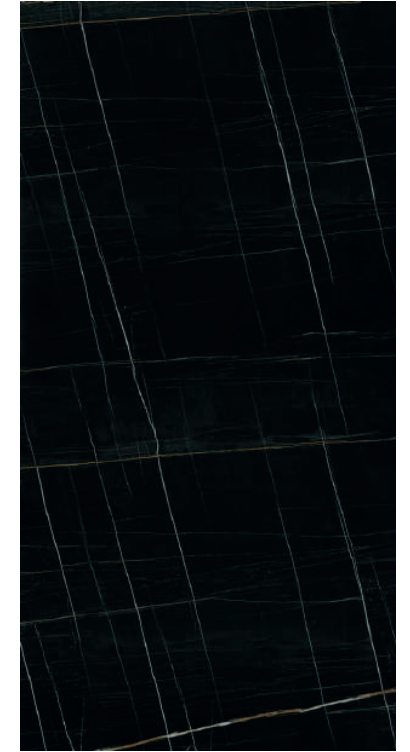

SAHARA NOIR

Lacquered cabinets

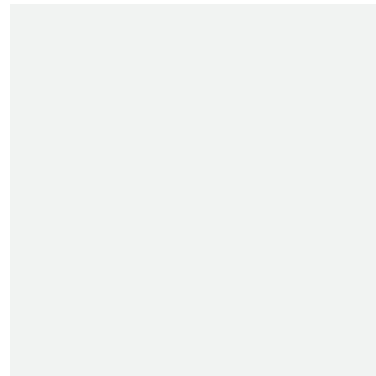

WHITE

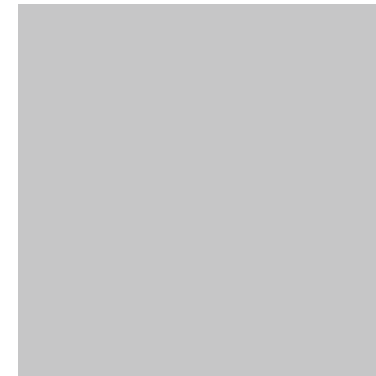

GREY



BLACK

Suggestions



EXTRA STATUARIO + WHITE



PIETRA GREY + BLACK



Main en suite bathroom finishes

The marble tiling is durable, long-lasting and requires little maintenance. The prominent features are the decorative tiles, which are used to create unique combinations for each customer.

MARMI & PADOVA



MARMI & SAINT LAURENT

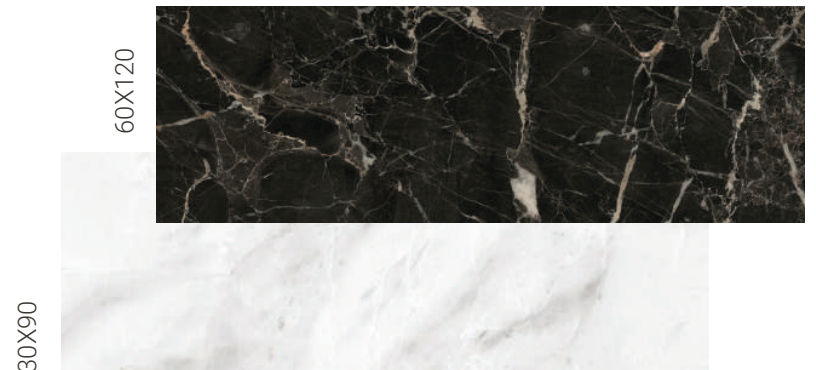



Finishes for bathrooms 1 and 2

ATRIO CREAM & RELIEF



MICROTECH LIGHT MATT PLAIN & LILLE LINES CREAM RELIEF



Bedroom 1

**EXTRA: LACQUERED SLAT PANNELLING



Suite 2

**EXTRA: LACQUERED SLAT PANELLING





Master bedroom

Outdoor finishes



FAÇADE FINISH

White continuous monocouche render.

Rectified porcelain tiles
37x150 / 25x150



COUVET STRONG OAK

SWIMMING POOL FINISH Porcelain tiles 30x60

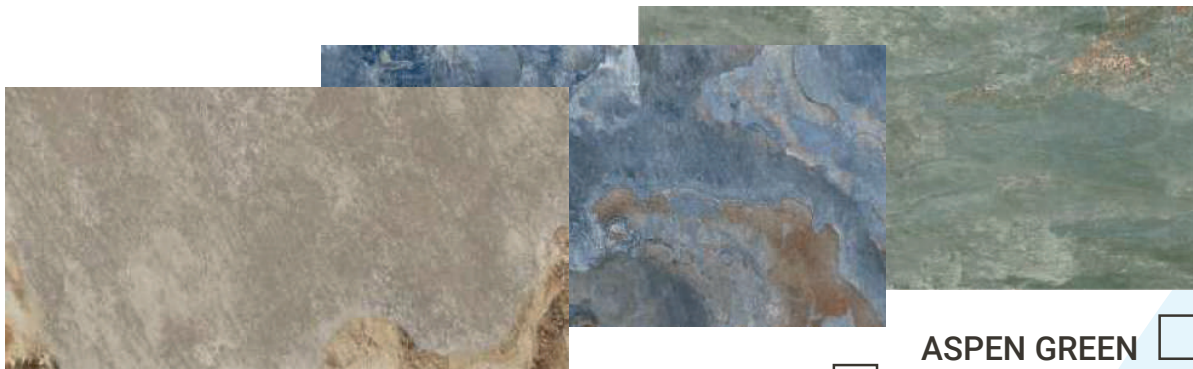

ASPEN EARTH

ASPEN BLUE

ASPEN GREEN

****EXTRA**
 BIOCLIMATIC SLATS
INSIDE THE PERGOLA

The bioclimatic pergolas are like natural air conditioning systems that you can control while you save energy, create more living space and add a charming design to your home.

It is an efficient and cost-effective option to enjoy outdoors at any time of the year.