



Unique *design* and
exclusive *situation*

Corallisa is unique in its close proximity to Ibiza Town and its marinas, whilst offering **tranquil seclusion and privacy** in one of the most stunning and sought after areas on the island.

This development is not only exclusive in that it borders and overlooks the **Roca Llisa golf course**, it also boasts **controlled access and outstanding security**, and provides all the **premium services of a high-end gated community**.

Throughout Ibiza you will not find a more **authentically styled, exceptionally designed, prestigious development** that respects and integrates with its **natural environment** and surroundings and offers enchanting views.



Location and distances

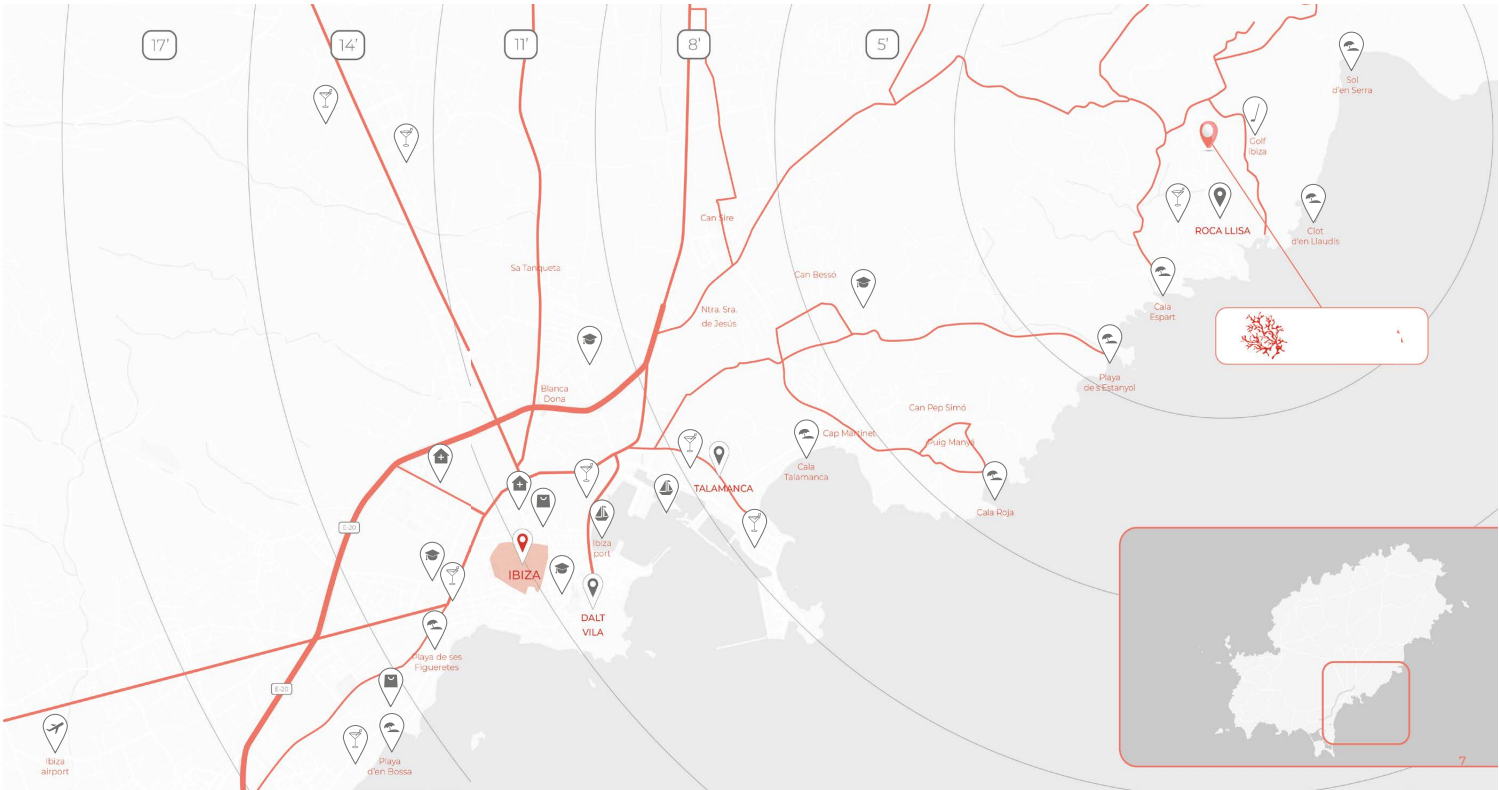
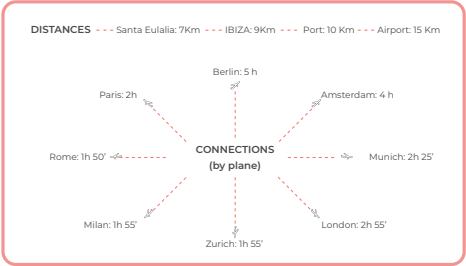



Our priorities:
privacy and protection

The exclusivity of the Corallisa estate starts with **secured access to the complex**. Owners, and their authorised guests, will first pass the secured entrance of Roca Llisa, then through the **manned security gate** permitting access to the Corallisa domain.

Each property sits on a **landscaped plot of at least 1,500m²** with **complete privacy** from neighbouring residences. The building density has been kept minimal so that each villa magically coexists with its woodland surrounding in this beautiful and privileged environment.

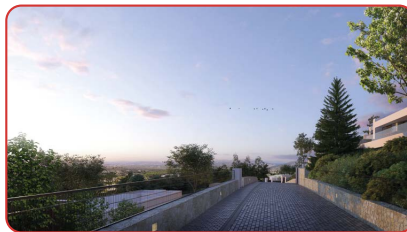

*Encompassing exceptional
innovation, architecture
and style*

The Corallisa domain embraces the **innocence and diversity** that comprises Ibiza's unique style by incorporating the textures and forms which shape the indigenous aesthetic of the island.

Tree-lined infinity pools, local stone, exceptional diffusion of natural light, optimum energy efficiency, and seamless integration of interior and exterior space, are all standard features of the innovative architecture of the **Corallisa luxury villas** - where **supreme comfort meets eclectic design**.





*Total seclusion
and spectacular views*



16 Close approximation of the view of villa 4

*Efficiency and integrity
complement superlative
specifications*

The build specifications are to an **exemplary high standard** with intricately selected elements, **outstanding materials** for flooring, windows & doors, and state of the art appliances for kitchens & bathrooms, all underscoring the **exceptional design and architectural features**.





*Personalisation:
the individual touch*



Sustainable and energy efficient build certifications

Strong environmental credentials are also a priority. Corallisa Signature Homes incorporate **energy efficient installations** such as aero-thermal systems for high performance year-round interior climate and air quality control whilst respecting our external atmosphere. The villas have been designed for **optimal use of natural resources** in water consumption including rainwater collection, cisterns and filters.

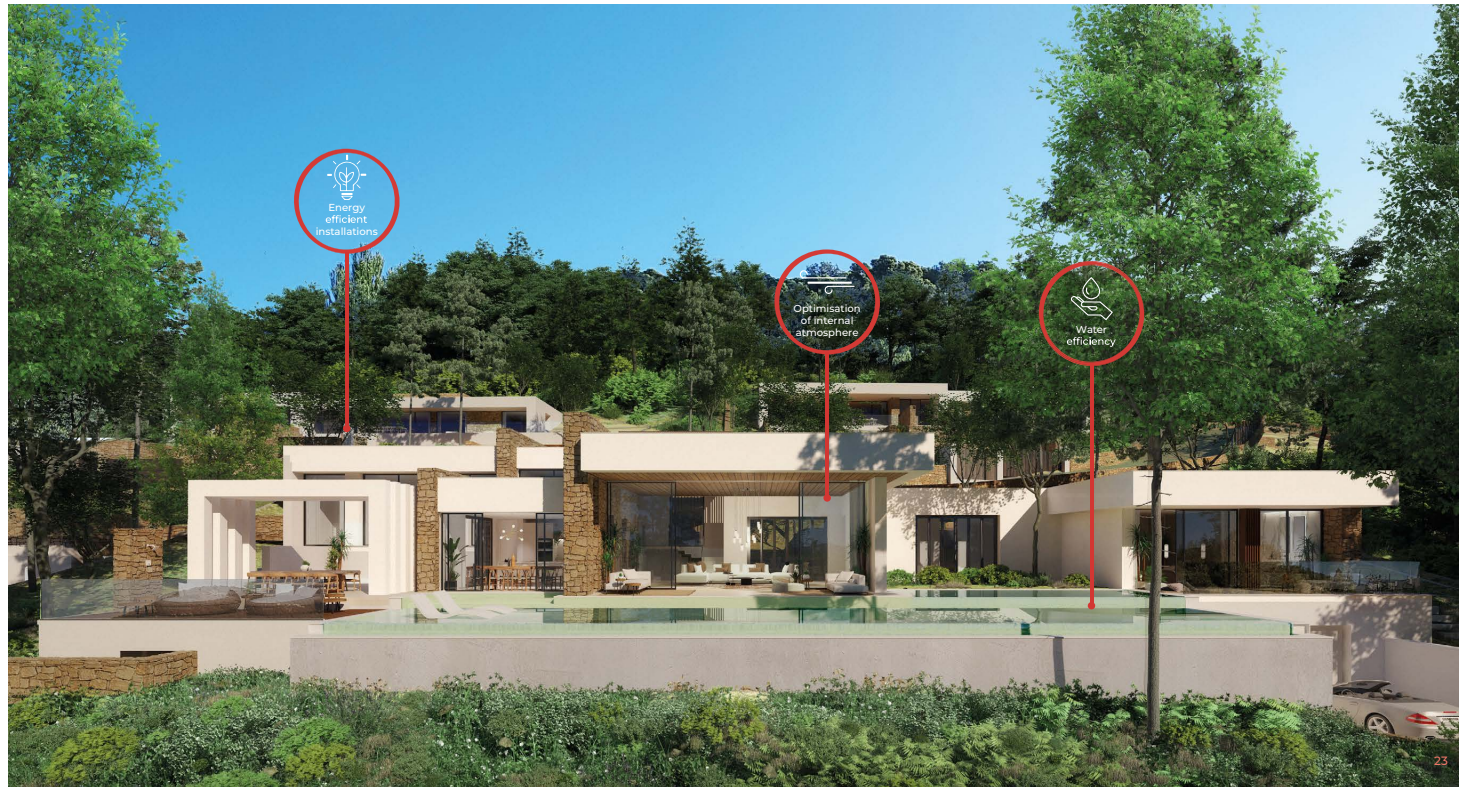

Types of villas

Location



Type A

Villa with **five bedrooms** and spectacular golf views built on **two levels** plus a **basement**. Main access through upper level which features a master suite and two bedrooms. The lower level features a spacious living area that extends towards the infinity pool. On the same floor there is a separate two-bedroom area for guests.

Type B

Villa with **four bedrooms**, panoramic views and plenty of privacy. Luxury on **one floor**, clearly separating the entertainment area from the four bedrooms. The living room, open kitchen and outdoor areas are perfect for gatherings. Spacious **basement** and garage.

Type C

Villa with **four bedrooms** built on **one level** plus a **basement** and **garage**. The property is divided into three independent spaces all of which have individual pool access. Night, day and entertainment areas are ideal to enjoy events, friends and family gatherings.

Type D

Villa with **four bedrooms**. The first level is similar to villa type C. The second level features a spectacular master suite. The living room has a **double height ceiling** and a 7m. tall front window that connects the indoor with the outdoor areas and allows enjoyment of the Ibiza sunrises.

Type A

The villa in its unique setting



Type A

Living area



Type A

Other areas



Type A

Areas



AVERAGE AREAS		sqm			
Plot surface	1500	Basement	170	Covered terrace	40
		Ground Floor	195	Uncovered terrace	150
		First Floor	155		
		TOTAL	520		

The above areas are representative and may vary slightly for individual villas.

Type B

The villa in its unique setting



Type B

Living area



Type B

Other areas



Type B

Areas



AVERAGE AREAS		sqm			
Plot surface	1515	Basement	165	Covered terrace	55
		Ground Floor	320	Uncovered terrace	180
		First Floor	-		
		TOTAL	485		

The above areas are representative and may vary slightly for individual villas.

Type C

The villa in its unique setting



Type C

Living area



Type C

Other areas



Type C

Areas



AVERAGE AREAS		sqm			
Plot surface	1520	Basement	270	Covered terrace	45
		Ground Floor	320	Uncovered terrace	94
		First Floor	-		
		TOTAL	590		

The above areas are representative and may vary slightly for individual villas.

Type D

The villa in its unique setting



Type D

Living area



Type D

Other areas



Type D

Areas



AVERAGE AREAS		sqm			
Plot surface		Basement	185	Covered terrace	40
		Ground Floor	210	Uncovered terrace	75
		First Floor	140		
		TOTAL	535		

The above areas are representative and may vary slightly for individual villas.

