

GRUNDSTÜCKSGRENZE

25.00

2.45 | 1.35 | 3.18⁵ | 2.03 | 2.81 | 1.35 | 2.87⁵ | 3.32 | 1.35 | 2.25

2.11 | 2.11 | 2.03 | 1.25 | 2.03 | 1.25 | 2.03 | 1.25 | 1.35 | 1.69 | 1.69 | 5.60

5.47 | 4.63 | 4.50 | 4.50

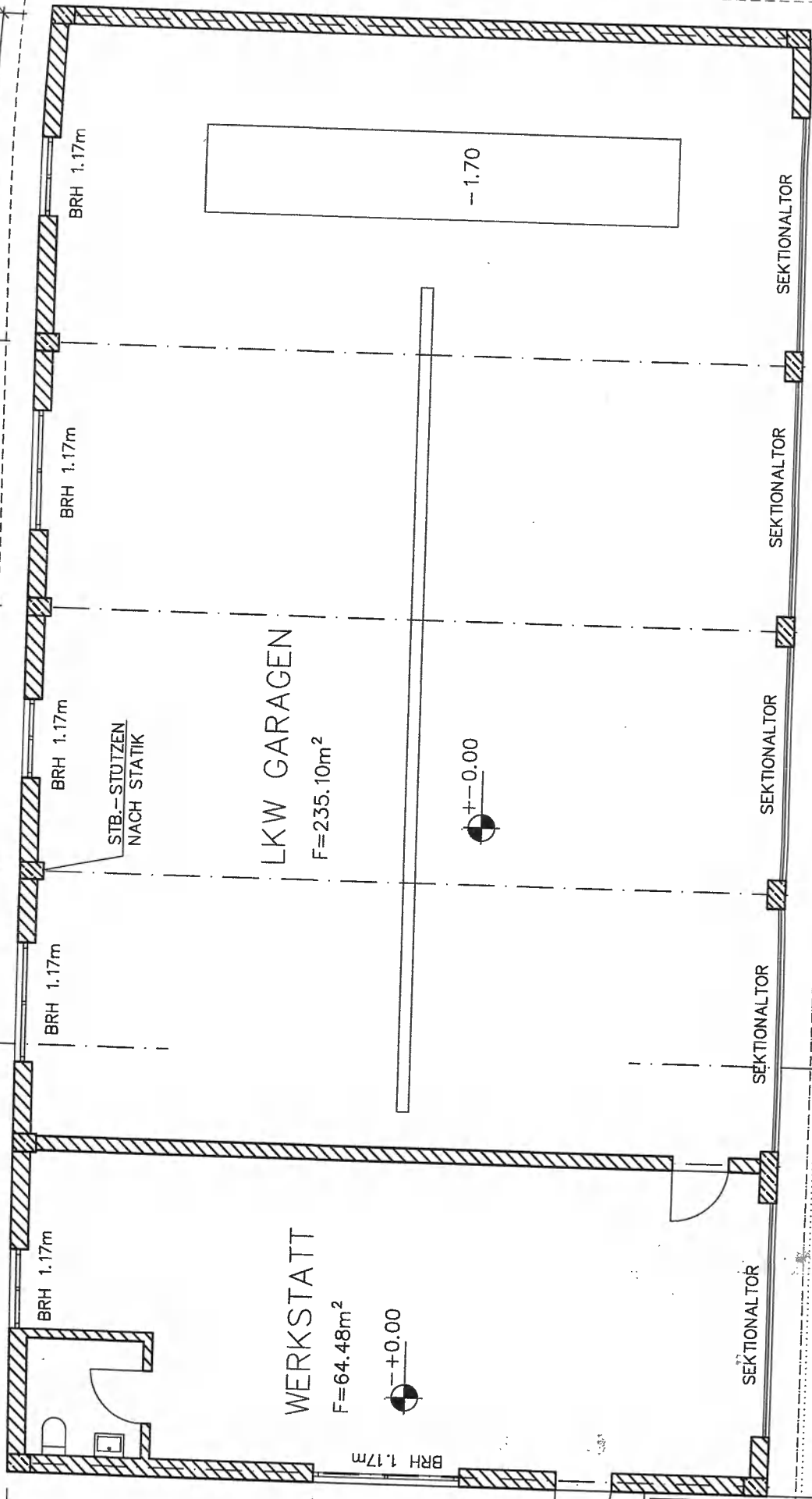

BRH 1.17m

BRH 1.17m

BRH 1.17m

BRH 1.17m

BRH 1.17m

STB.-STÜTZEN
NACH STATIK

LKW GARAGEN

F=235.10m²

WERKSTATT

F=64.48m²

±0.00

-1.70

SEKTIONALTOR

SEKTIONALTOR

SEKTIONALTOR

SEKTIONALTOR

SEKTIONALTOR

1.00

4.00

1.87

4.13

5.0

4.00

5.0

4.00

1.50

1.50

30

4.25

4.25

18.96

4.25

5.0

4.25

4.00

4.25

4.25

5.20

24

5.50

30

3.50

15

5.47

4.63

4.63

4.50

4.50

4.50

4.50

5.60

11.00

2.48

2.48

5.26

5.26

9.37⁹

2.66¹

96

2.01

2.01

2.00

2.00