







# LEGENDE

-  2-fach Steckdose IT
-  3-fach/ 2-fach Steckdose AV
-  2-fach RJ45
-  X-fach Anschlussdose TAE
-  Anschlussdose VDO
-  Brüstungskanal
-  Jalousietaster

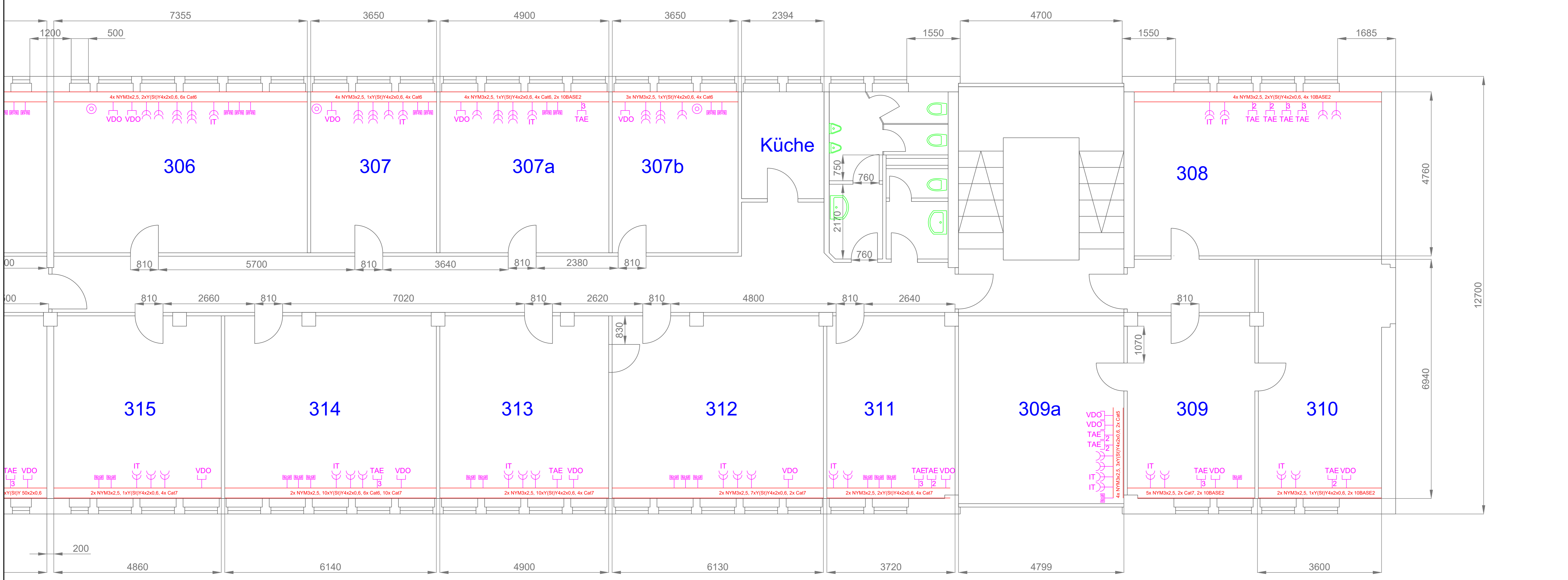
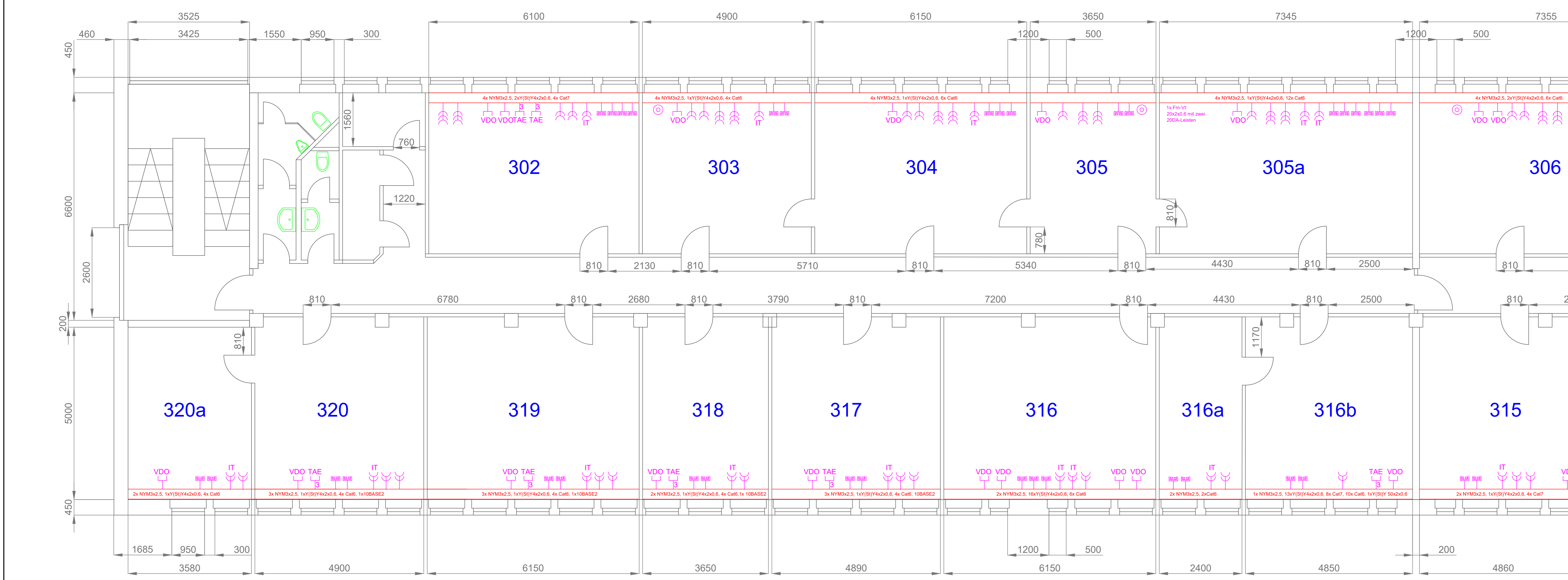

Hr.	Datum	gez.	Art der Änderung	Hr.	Datum	gez.	Art der Änderung
			Änderung Hochbau				Änderung TGA

Gebäude  
**Bürogebäude Bennostraße 2**

Bezeichnung  
**Grundriss 3. Obergeschoss**

Bauherr  
INTECH Verwaltungsgesellschaft mbH, Berlin  
Bennostraße 2, 13053 Berlin

Planverfasser  
**VPA** VPA Ingenieurgesellschaft mbH  
Zimmermannstr. 21, 12163 Berlin

Blattgröße	Maßstab	Gezeichnet	Geprüft
841x1189	1:50	SJM	Hei

Datum  
10.07.2019