

SONNEN-
TERRASSE

STAHLSTÜTZE

HAUSWIRT-
SCHAFT
8,92m²

SPEISE
4,08m²

KIND-
GÄSTE
14,98m²

WC
3,35m²

DIELE
17,49m²

TREPPENR.
3,95m²

WOHNEN
44,98m²

KACHEL-
OFEN

ESSEN
20,56m²

KOCHEN
8,85m²

GARDEROBE

B

Erdgeschoss

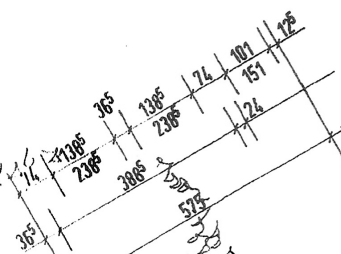
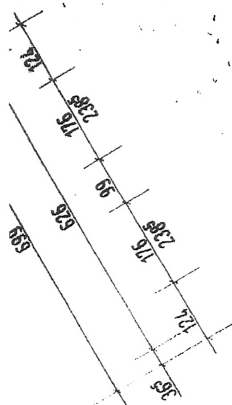

000

050