

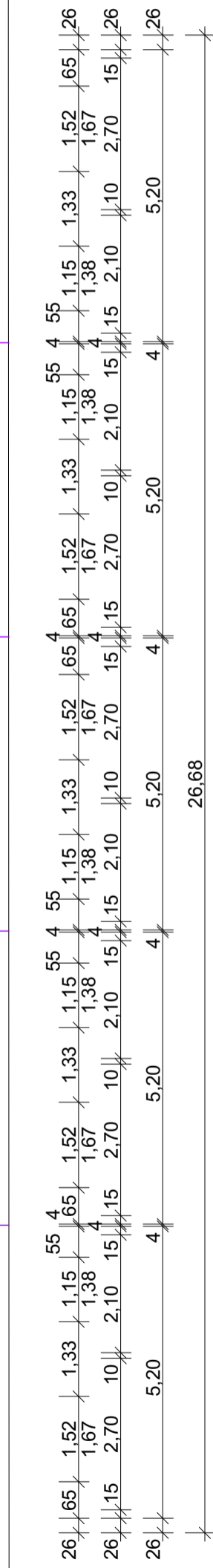

Landstraße

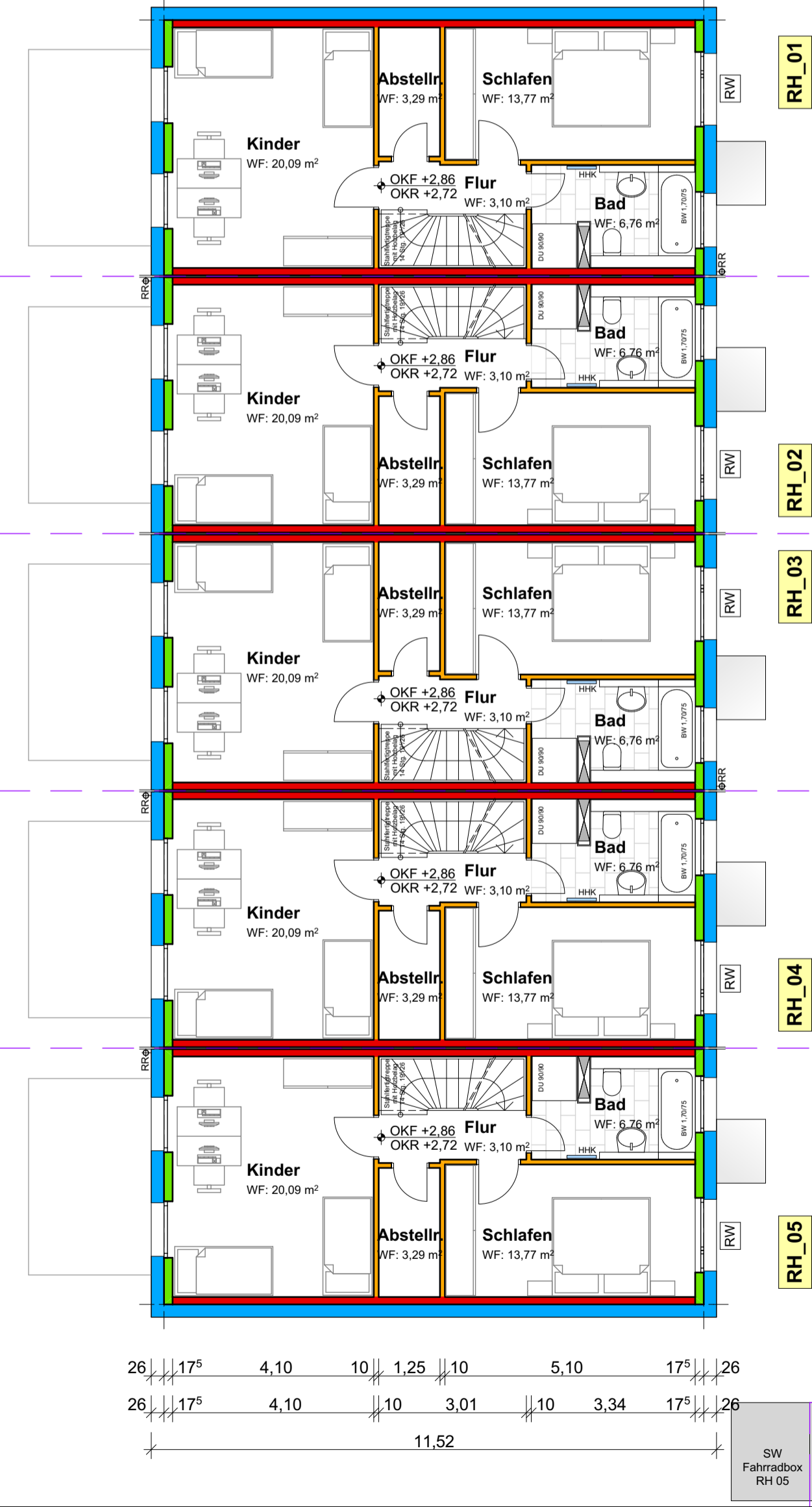
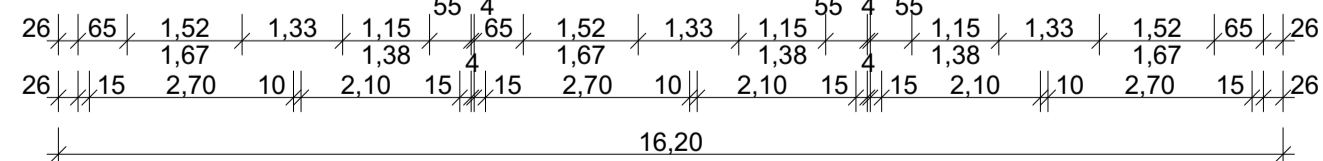
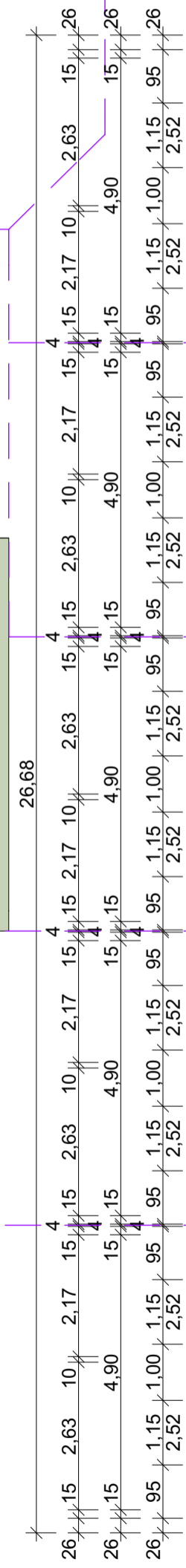
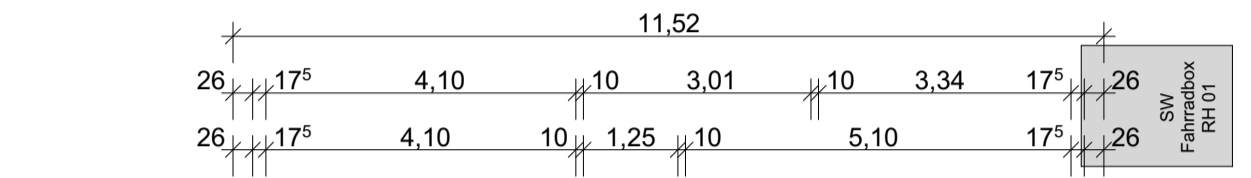
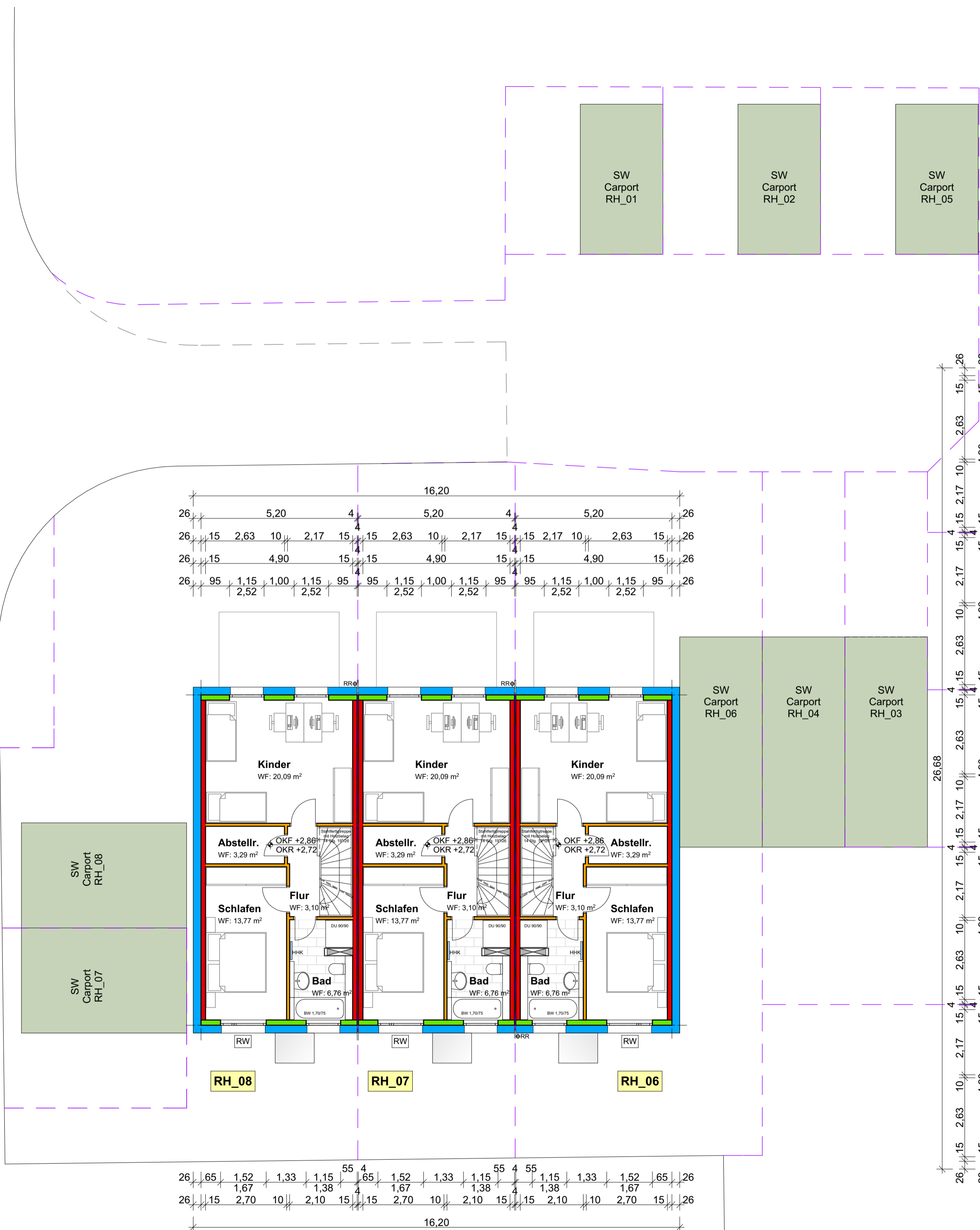
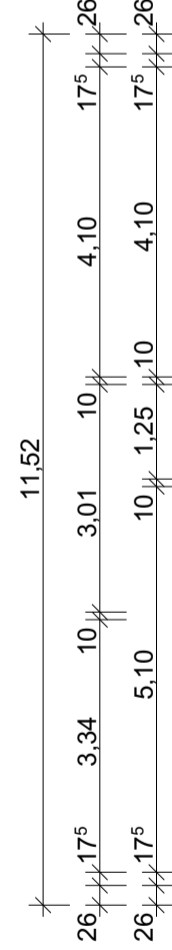

INDEX	DATUM	ÄNDERUNGEN
A	-	-

		Ludwig-Erhard-Allee 21 • 76131 Karlsruhe	
		PROJEKT Neubau von 8 Reihenhäuser, 8 Carports und 8 Stellplätzen Landstrasse 76547 Sinzheim	
PLANUNGSPHASE	Baueingabe	M	1:100
PLANINHALT	Obergeschoss RH 01-08	DIN	93/45
		GEZ	SP
		D	11.05.2023
PLANBEZEICHNUNG	BE 03_ARCH_01-08_BE_OG_2023.05.11		
BAUHERRSCHAFT	Hoepfner Amboisé Liegenschaft GmbH & Co.KG Rintheimer Strasse 33 76131 Karlsruhe		
PLANVERFASSER	Architekturbüro Harald Klippert Riefstahlstrasse 8 76133 Karlsruhe		