



The project's newest phase offers **88 exclusive homes** specially designed for you **to enjoy the Mediterranean lifestyle**. The south exposure, the glazed surface and the large terraces ensure an optimal use of sunlight.

Inside, **the unique distribution** is specially designed to offer spacious living areas where the interior is connected to the exterior areas to maximize light and space.

The open plan lounge area featuring the kitchen flows seamlessly and connects with the large terrace to provide a unique living area. The glass railing that encloses the large terrace affords unparalleled **views of the natural environment**.



## Facing South

In addition, you can choose between **2 and 3 bedrooms homes**, and you can also choose a **ground floor with a garden**, or a **penthouse with a solarium**.

All homes have a **garage** and a **storage room included**.

We have a plethora of options available so that you can find the home of your dreams.

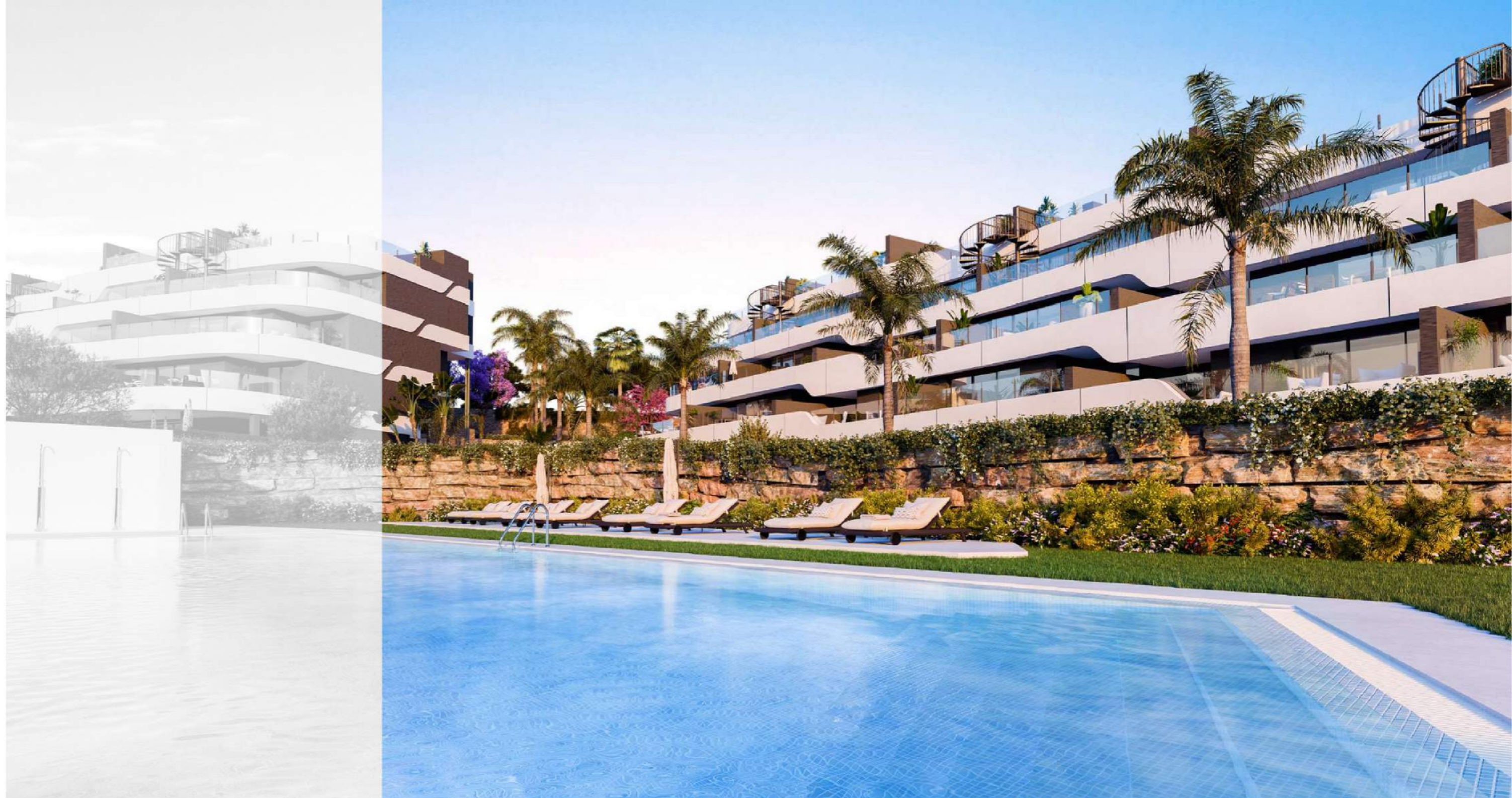

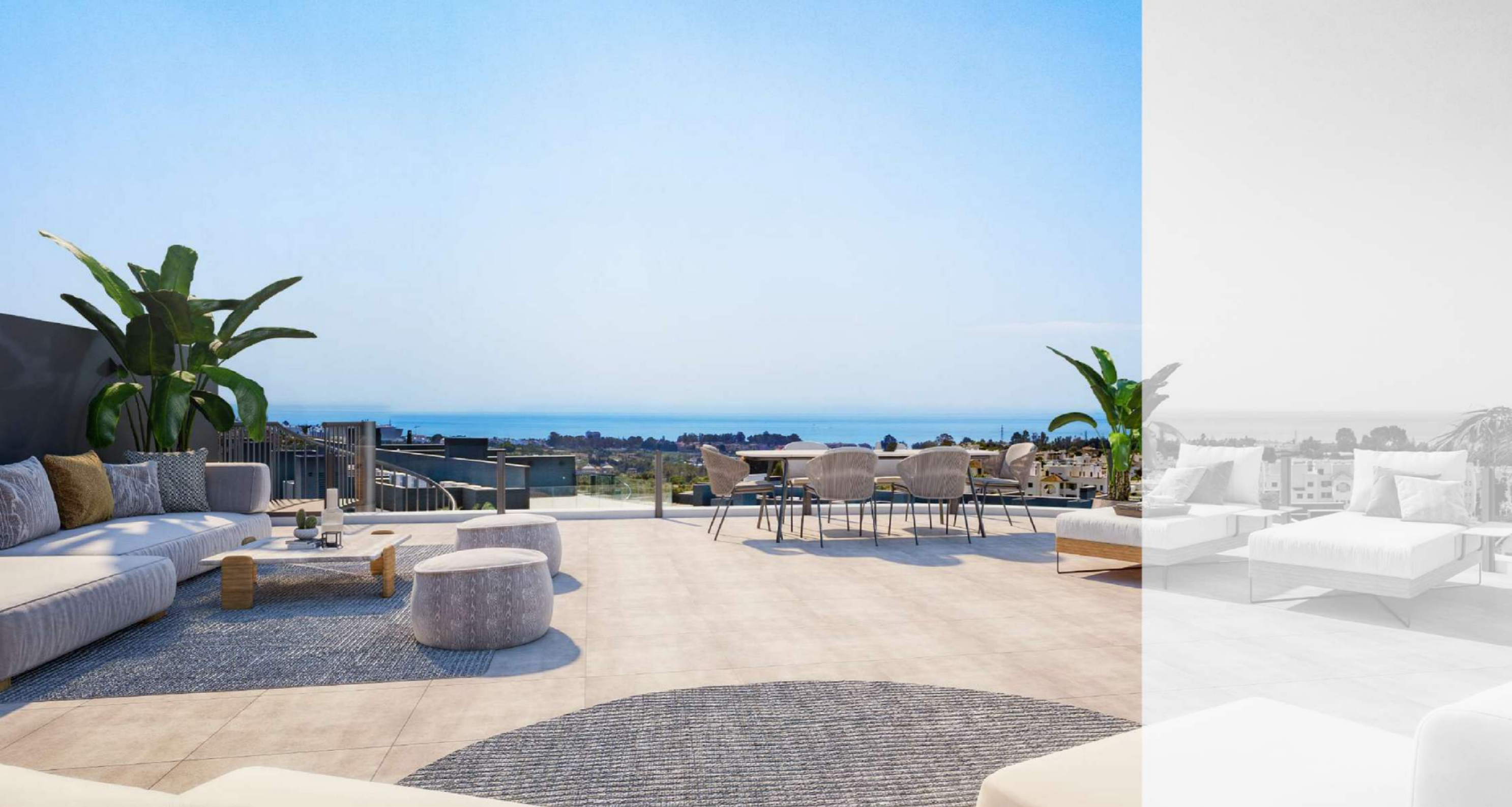

## Pure Living

The beautiful homes offer a choice of **2 and 3 bedroom apartments and penthouses**. The ground floors are perfect for a family and offer a large terrace and private garden area. The spectacular penthouses with solariums are perfect vantage points whereby one can enjoy **incredible views of the sea and surrounding landscape of Estepona**.

Relax in your private oasis and experience a unique lifestyle complemented by all the facilities of this truly beautiful development.

## Design and harmony

Imagine an oasis bathed in sunshine  
325 days a year, without interruptions,  
surrounded by amenities and enhanced  
by the light and the sea on the horizon.

Nature is integrated into the  
architecture. Design and privacy give  
shape to a residential project conceived  
to create a unique environment; **a refuge  
where you can enjoy the life that you  
had always dreamed of.**







## Pure Sun

The development offers avant garde architecture designed for your comfort and enjoyment.

The high quality of the materials used is complemented by the **unique architectural design.**

The remarkable orientation of the homes and their interior distribution have been specially conceived to make the most of natural light and the use of communal areas.

## Under the **Blue Sky**

The large terraces and the spacious rooms extend into the open communal and landscaped areas.

A large pool is located at the centre, this apart from being a unique focal point is also a space for enjoyment and relaxation. Protected from the outside by the buildings and surrounded by nature, **the pool is designed to be like a natural lake**, but private and offering a sense of complete tranquility.







## Pure Relax

In addition, **the gym and spa areas** add to the value of the design and **provide an area whereby one can simply relax, exercise or work from home in our stunning coworking area.**

A long list of details are designed to make your life easier, so you can enjoy the privileged climate of Estepona and the breeze of the Mediterranean Sea.

The building offers its owners an **exclusive and complete SPA** where you can immerse yourself in the water and simply relax and unwind.

Its direct access from the landscaped zone encourages relaxation and the enjoyment of fantastic facilities that are complemented by an area with changing rooms , toilets and showers.



## Pure Activity

Exercising the body will become a different way to relax and take care of our greatest treasure: our body.

For this reason, a large room has been provided with **high-quality cardio and training equipment**.



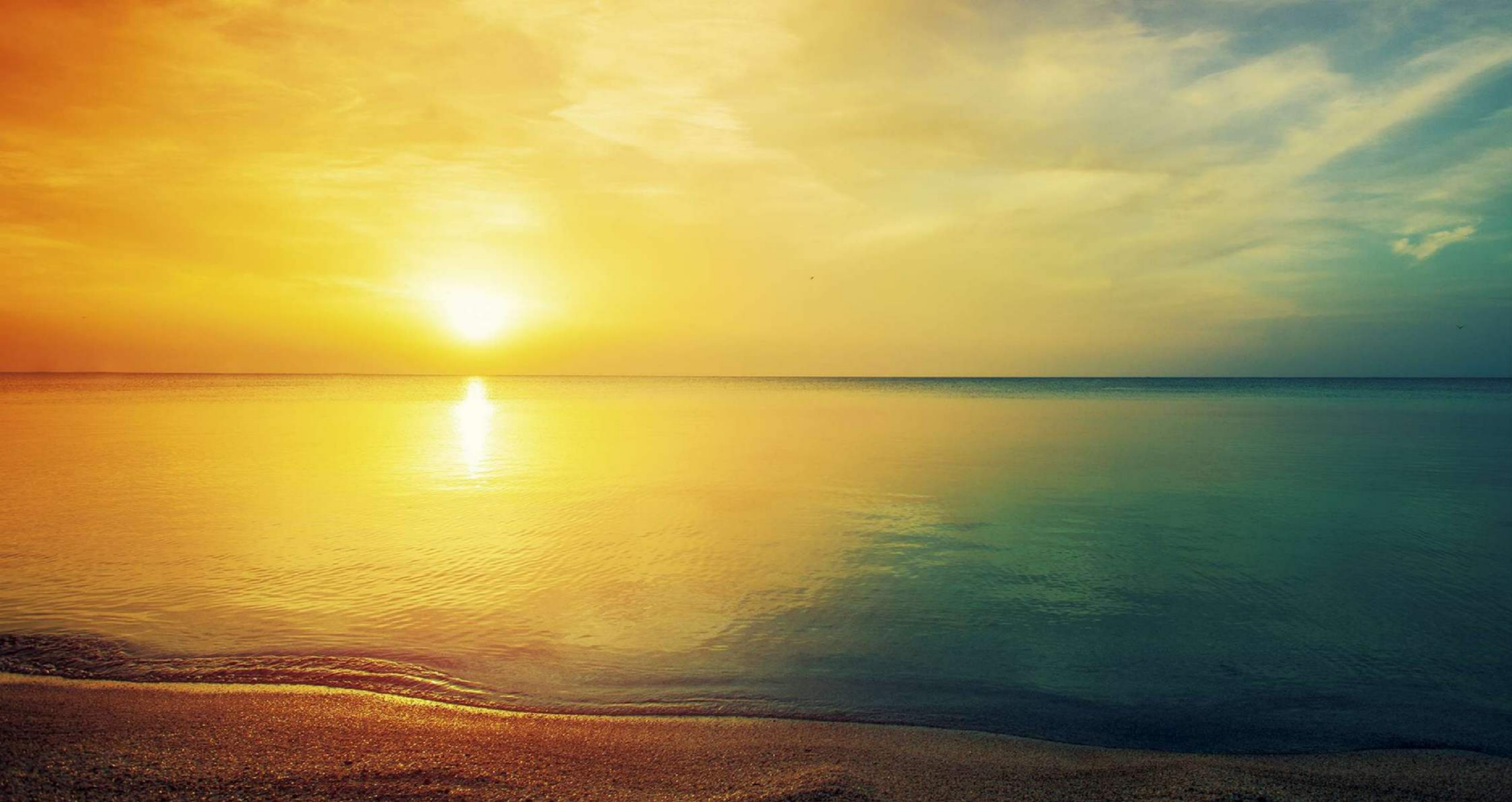

## A perfect view of the **Mediterranean**

The project is located in a **privileged enclave**, halfway between Estepona and Marbella, whose elevated position allows you to enjoy **unique views of the Mediterranean horizon**.

## Pure Life

The natural quality of the location is completed by its direct access to the main streets of the Costa de Sol.

In just 10 minutes, you can enjoy **prestigious golf courses**, the exotic and spectacular **Selwo Park**, **beach clubs with live music**, **restaurants with Michelin stars** and large shopping areas, as well as private clinics.

We provide all the possible services to guarantee the lifestyle that you have always wanted.



In the new phase, the architects have interpreted a **contemporary architecture that blends with the natural environment.**

The purity of the lines and the aesthetic quality of the interiors are the result of a **perfect compromise between form and function.**

Likewise, landscape integration and the inclusion of nature as a key element define the identity of a unique project in the Spanish residential landscape.

