

69

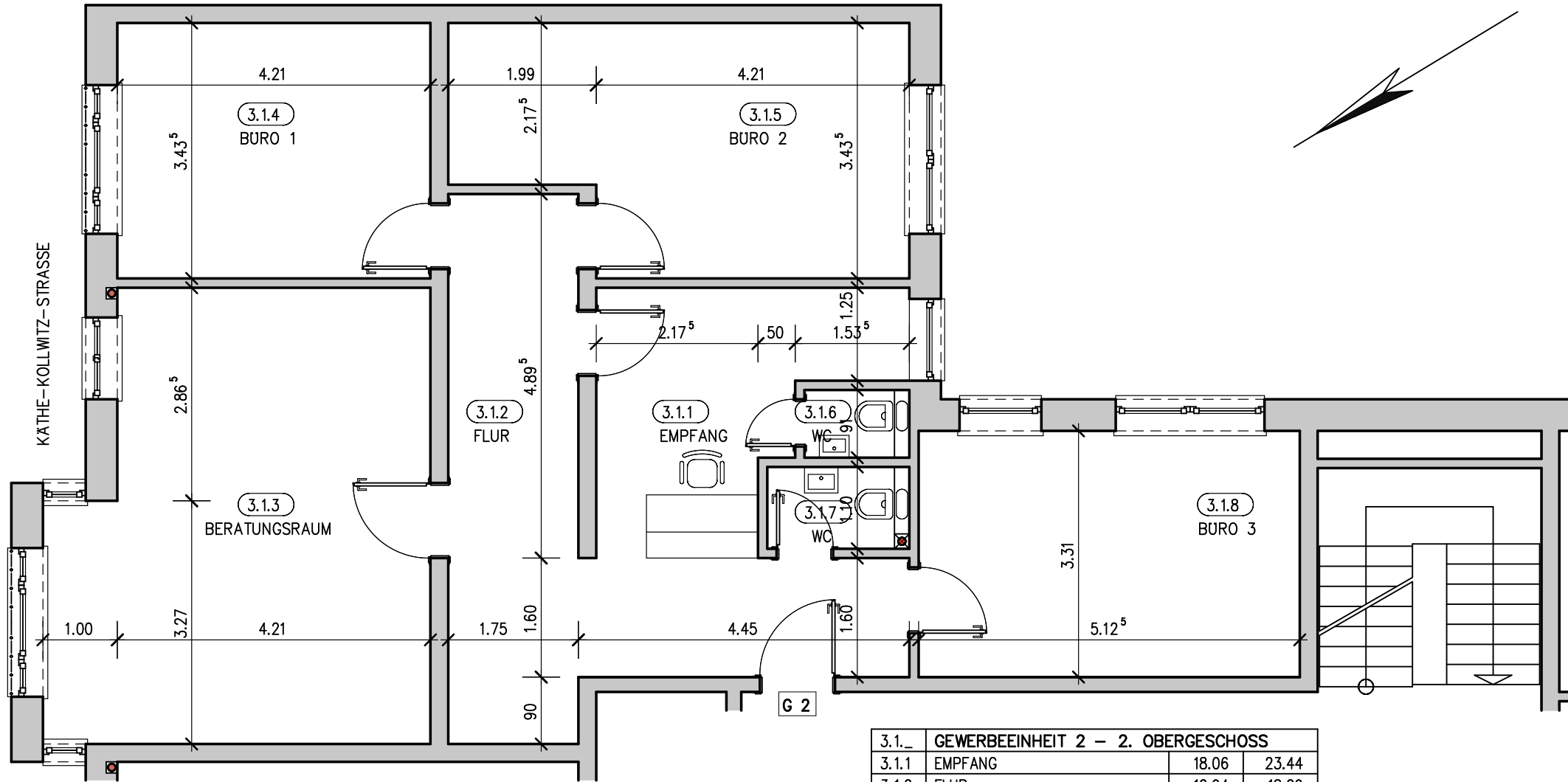

3.1._	GEWERBEEINHEIT 2 - 2. OBERGESCHOSS		
3.1.1	EMPfang	18.06	23.44
3.1.2	FLUR	12.94	18.29
3.1.3	BERATUNGSRAUM	29.01	22.66
3.1.4	BURO 1	14.46	15.29
3.1.5	BURO 2	18.79	19.27
3.1.6	WC	1.28	4.64
3.1.7	WC	2.10	6.02
3.1.8	BURO 3	16.96	16.87
SUMME [G 2]		113.60	>>>