

















































































KEDAJS1FBD \*

Schlumberger  
POITIERS FRANCE

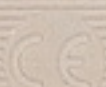

Res ●

Auto ☉ C1 C2 C3 I<sub>max</sub>

T<sub>in</sub>  
10'  
15'  
30'  
60'  
T<sub>out</sub>

16:31

Mo Di Mi Do Fr Sa So



+



-



MODE



a/b



ENTER

Tarifschaltuhr  
HZ 8111

N° 2098 07221



Un: 100/230V fn: 50/60Hz

U<sub>C1,2</sub>: 250V~ I<sub>C1,2</sub>: 3A

Gangreserve 5 Jahre

IEC 1038

Lagerung +50°C  
-25°C

Eigentum des Elektrizitätswerkes

WESAG



Anlagenschlüssel  
 Anzahl  
 Standort  
 Datum

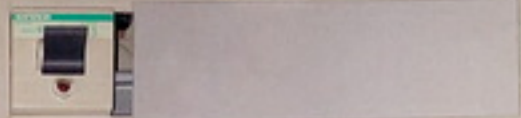

Anlagenschlüssel  
 Anzahl  
 Standort  
 Datum



SIMATIC 300  
 6ES7 307-1EA00-0AB0



SIMATIC 300 PS 307 5A  
 6ES7 307-1EA00-0AB0



SIMATIC 300  
 6ES7 307-1EA00-0AB0

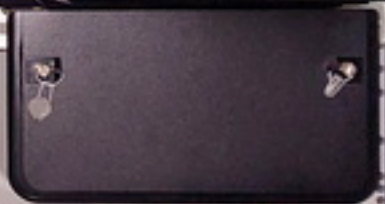

SIMATIC 300 PS 307 5A  
 6ES7 307-1EA00-0AB0

MESSUNG: Eingang 1  
 1. K. 2. 3. 4. 5. 6. 7. 8. 9. 10. 11. 12. 13. 14. 15. 16. 17. 18. 19. 20.

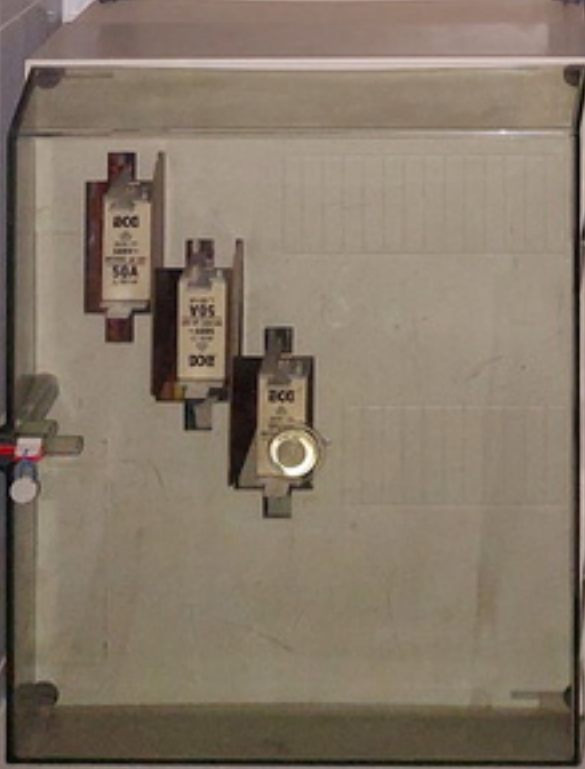

RCG 35A  
 V95 100V  
 RCG 35A



RCG 35A  
 RCG 35A  
 RCG 35A

100 V  
50/60 Hz



















Bertha von Kattonitz Straße 40 - Pöhsig



Grenzen lt. Originalkatasterplan



PETER FRENZEL  
IMMOBILIEN

Norden →

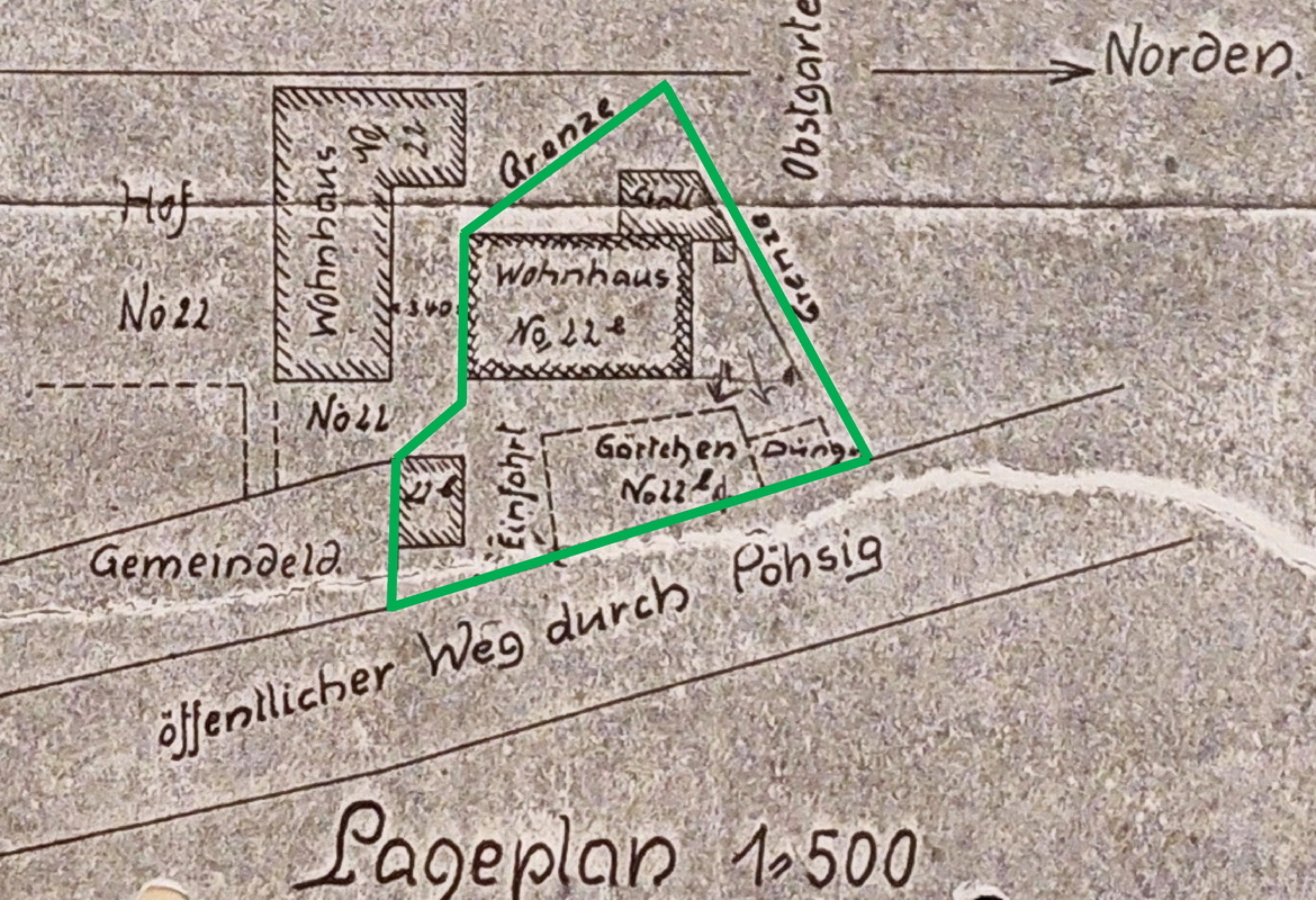

Lageplan 1:500