

Stadt Tettng  
Gemarkung Tettng  
**Lageplan**  
Maßstab 1:200

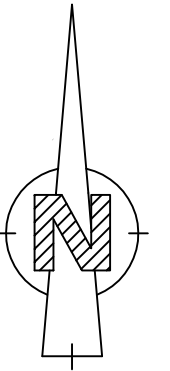

Gefertigt: 24.06.2019  
Ingenieurbüro für Vermessung  
Stefan Widmann Dipl.-Ing.(FH)  
Sachverständiger nach §5 Abs.3 LBOVVO  
Springerstraße 1 , 88214 Ravensburg  
Telefon (0751) 17557, Fax (0751) 31639

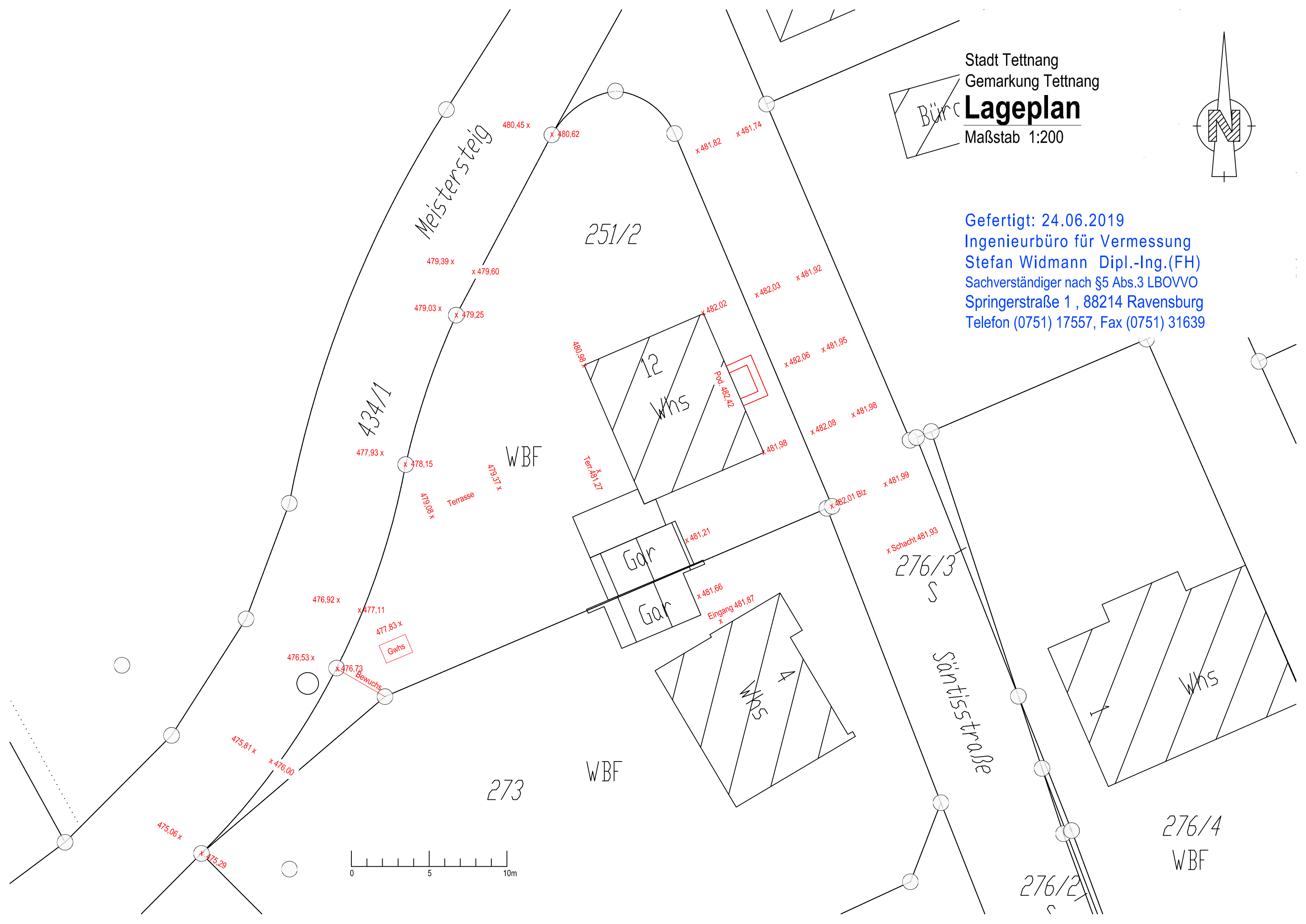

Meistersteig

251/2

434/1

WBF

12  
Whs

276/3  
S

Säntisstraße

276/4  
WBF

273

WBF

276/2  
C



475.06 x

x 475.29

475.81 x

x 476.00

476.53 x

x 476.73

476.92 x

x 477.11

477.83 x

Gwhs

477.93 x

x 478.15

479.09 x

Terrasse

479.03 x

x 479.25

479.39 x

x 479.60

480.45 x

x 480.62

480.98 x

x 481.21

x 481.66

Eingang 481.87 x

x 481.82

x 481.74

x 482.03

x 481.92

x 482.06

x 481.95

x 482.08

x 481.98

x 481.99

x Schacht 481.93

x 482.01 Blz

x 481.98

x 482.02

Pod-482-42

Terr-481-27

Bewuchs

Gar

Gar

Whs

Whs

Büro