

GRUNDRISS ERDGESCHOSS

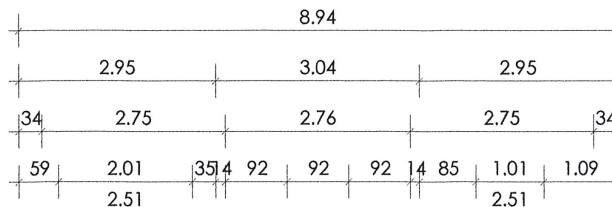

Mauerwerk POROTON Hlz - 0,8
Druckfestigkeitsklasse 8

äußeres WDVS d = 10 cm
silikatischer Außenputz

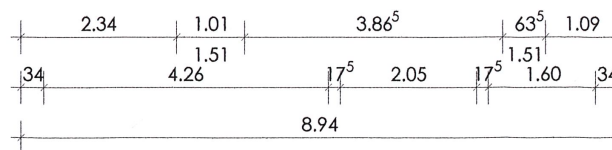
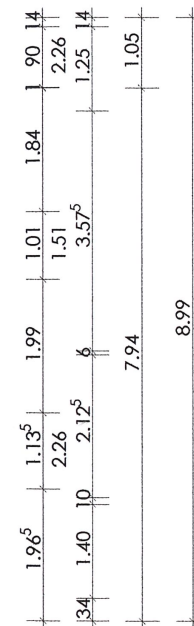
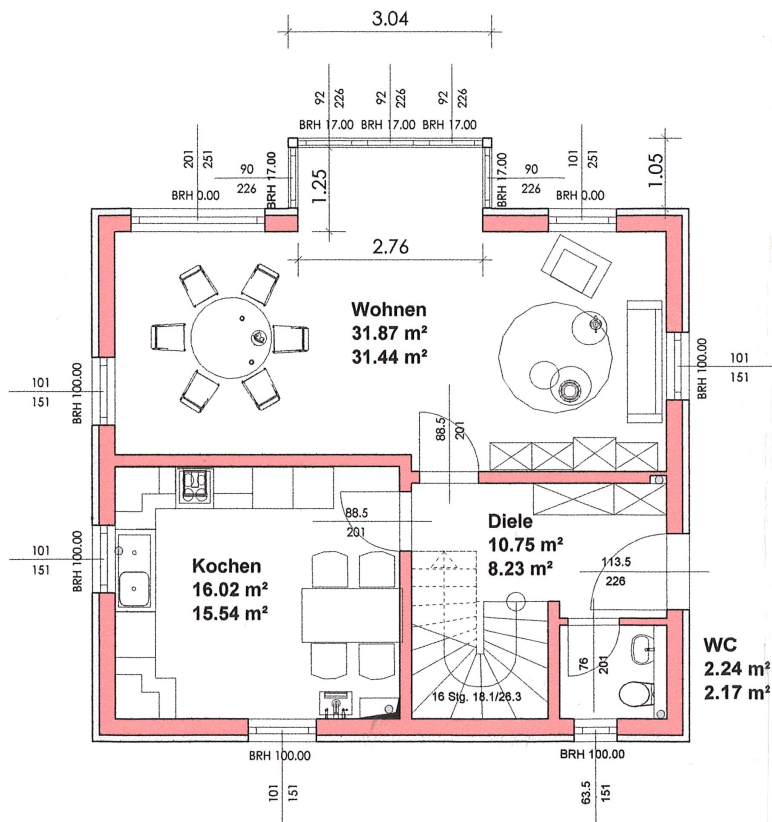
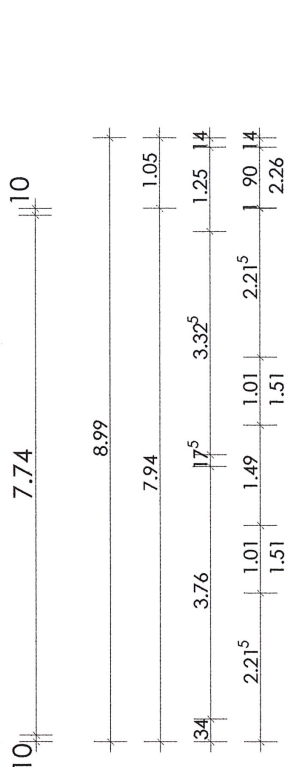

OK FERTIGFUSSBODEN EG
+ 0.17



OK ROHFUSSBODEN EG
± 0.00

