

Seniorengerechtes Wohnen Wald
Irma-Holder-Platz 4, 93192 Wald

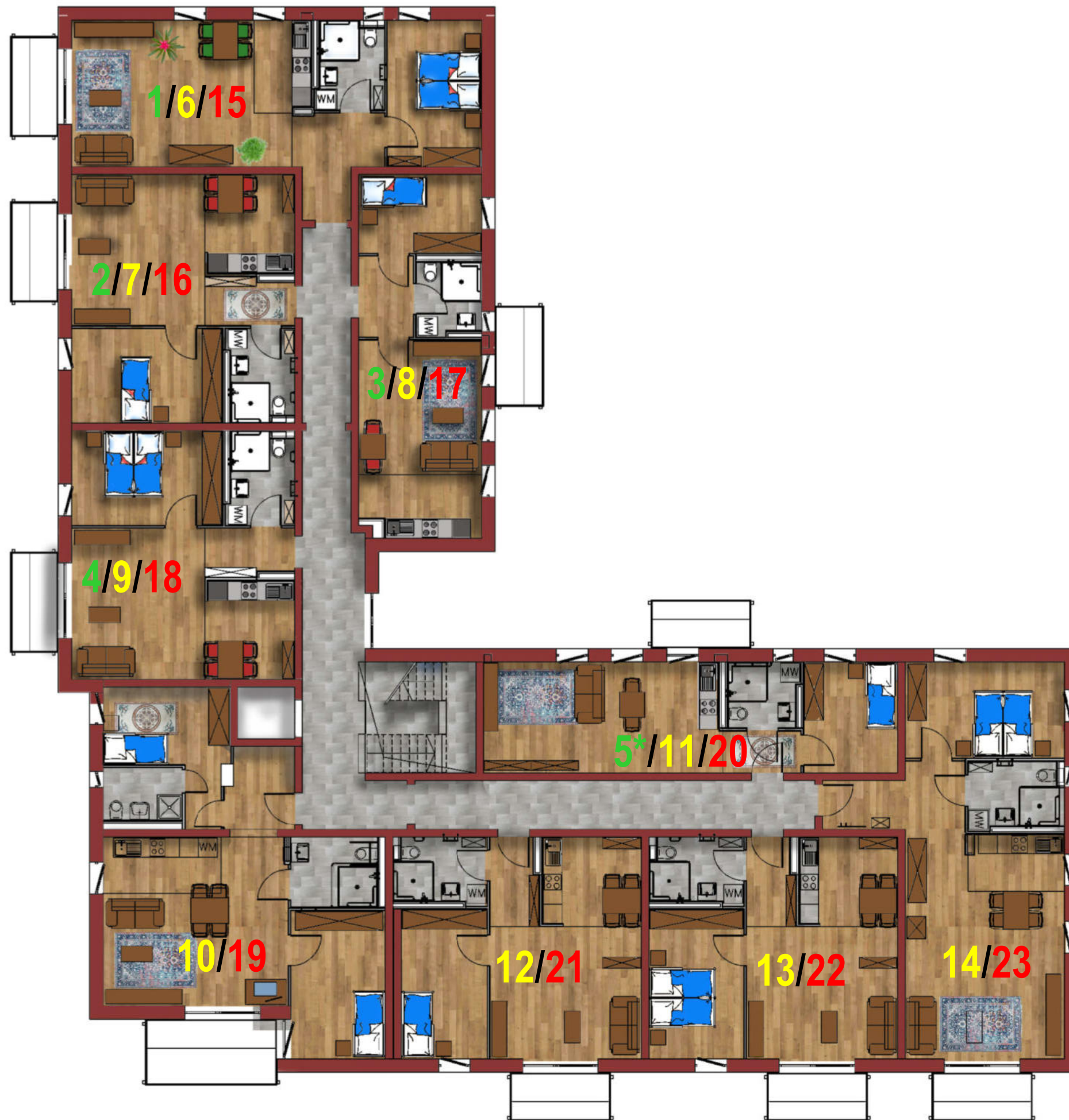

EG / 1OG / 2OG

- 1/6/15 = ca. 62,70m²
- 2/7/16 = ca. 54,96m²
- 3/8/17 = ca. 44,23m²
- 4/9/18 = ca. 54,95m²
- 5* = ca. 81,68m²
- 11/20 = ca. 45,25m²
- 10/19 = ca. 75,43m²
- 12/21 = ca. 54,60m²
- 13/22 = ca. 54,60m²
- 14/23 = ca. 66,68m²