

LOCATION

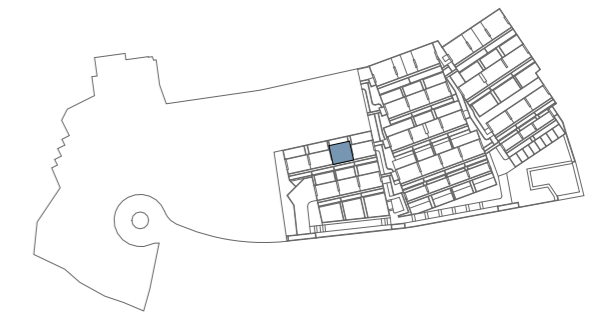

APPROXIMATE AREAS

Entrance	5,06 m ²
Living Room/Kitchen	27,68 m ²
Hall	2,42 m ²
Master Bedroom/Walk-in Dresser	13,51 m ²
Bedroom 2	11,22 m ²
Master Bathroom	3,92 m ²
Bathroom 2	3,68 m ²
Internal Useful Floor Area	67,49 m²
Covered Terrace	26,79 m ²
Garden	33,21 m ²
External Useful Floor Area	60,00 m²

Internal built area	77,52 m²
Internal gross area including PP. Common Area*	121,68 m²
Regarding Decreto BOJA 218/2005	
Total useful floor area	74,24 m²
Total built area	133,84 m²

*Terraces are not included

Apartment 062 - Block B09 - Floor PB0 - Door C

0 1 2 3 4 5m

The information contained may be modified during the course of the work execution due to technical or legal requirements, without implying any reduction in the overall level of qualities. The access steps to the dwelling and exits to courtyards may be altered according to the level of the streets and it is up to the D.F. to set the criteria.