

41 — 19 — 3.41 — 19 — 2.21 — 19 — 2.21 — 19 — 3.38⁵ — 11⁵ — 3.51 — 32

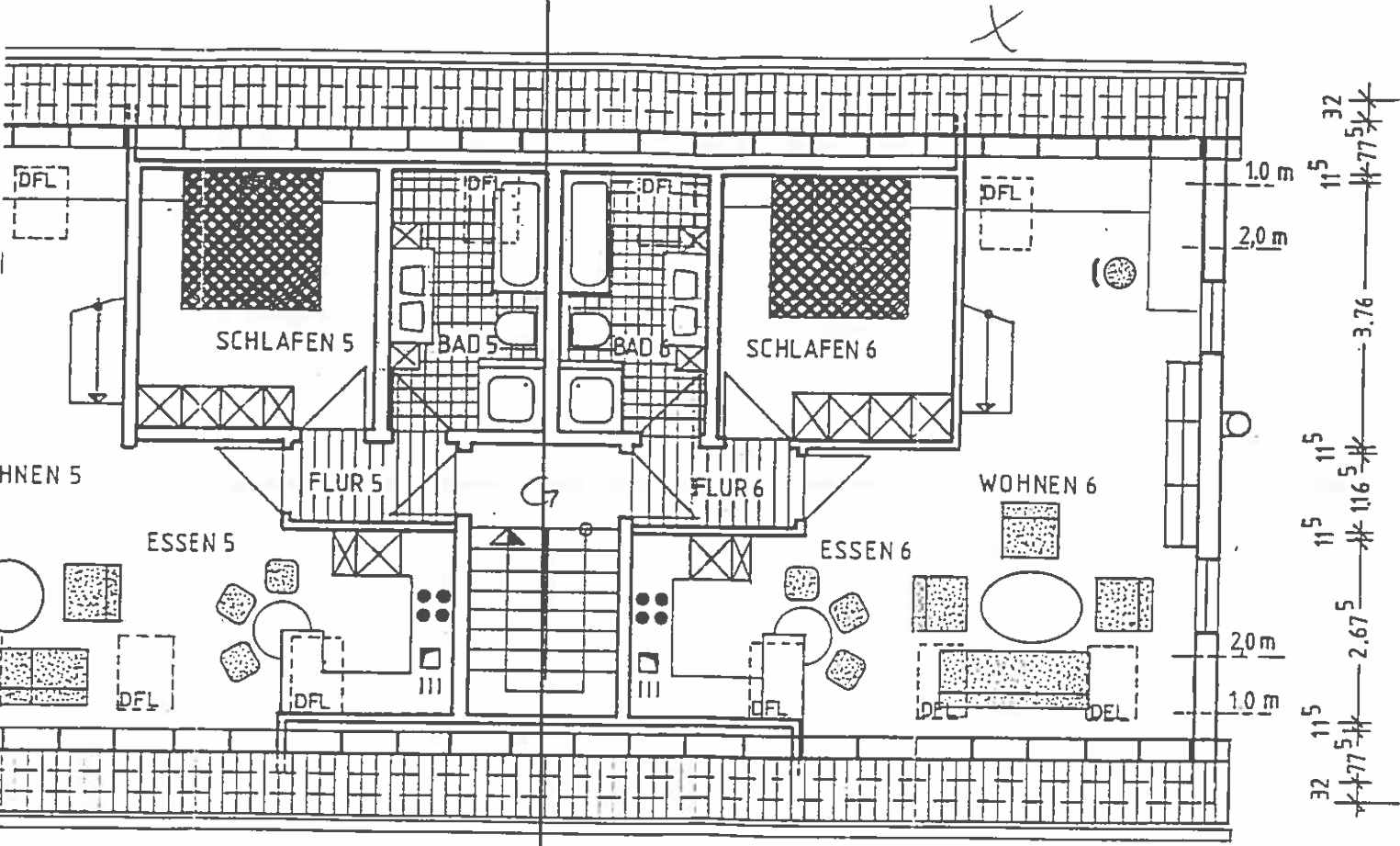

1.0 m
2.0 m
1.0 m
2.0 m
1.0 m
3.76
11⁵
11⁵
11⁵
11⁵
11⁵
32

5.69⁵ — 11⁵ — 2.40 — 19 — 2.21 — 19 — 2.40 — 11⁵ — 5.69⁵ — 32
19.65