

Whg.1 1.OG

Zimmer 1

Flur

Badezimmer

Zimmer 2

HK h/b=600/1400 Typ DK 22

Therme
Buderus
GB152-24K

Typ DK 22
HK h/b=600/800

Typ DK 22
HK h/b=600/800

Typ DK 22
HK h/b=600/800

Typ DK 22
HK h/b=600/800

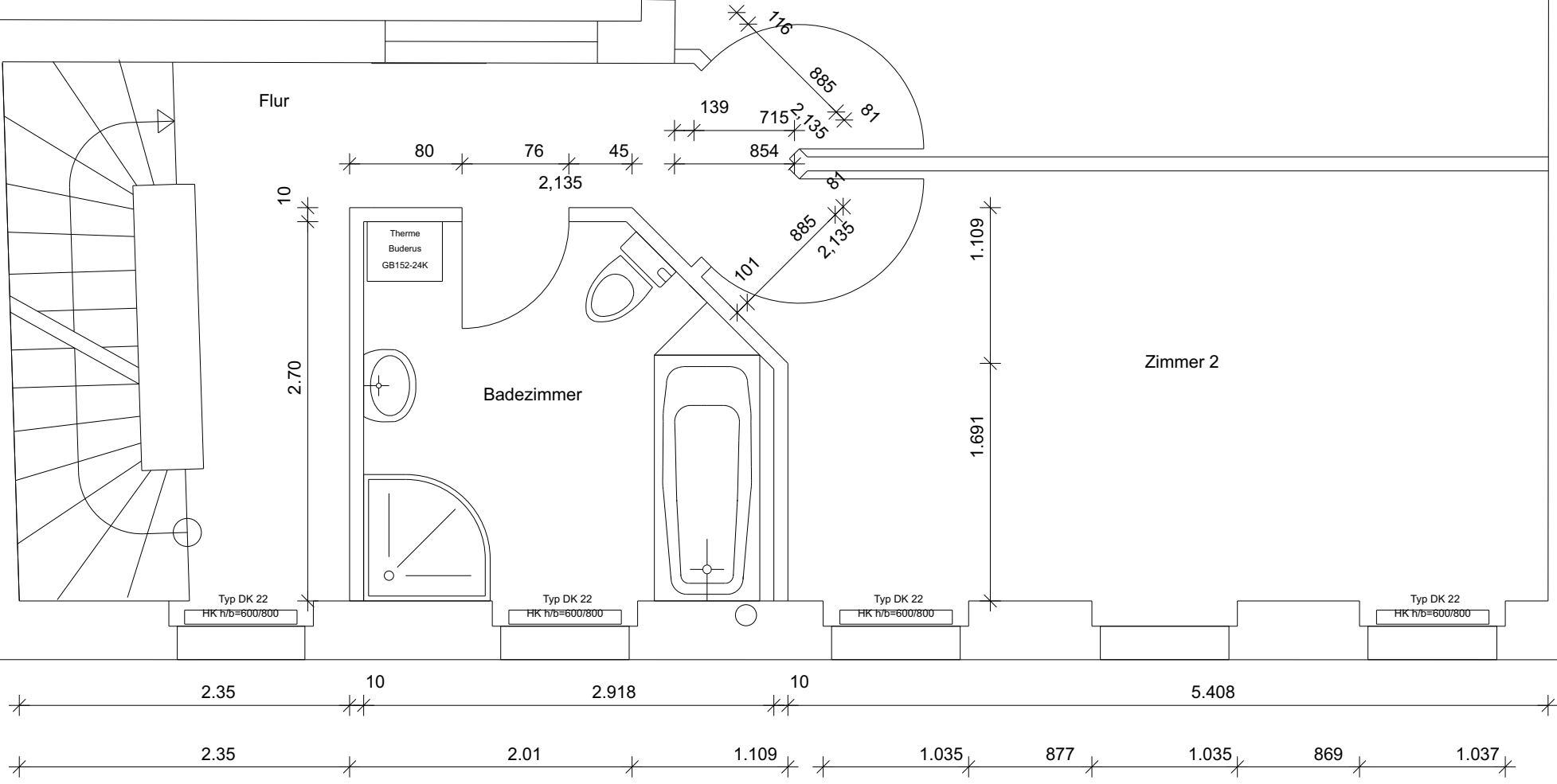

10
3.062

2.35 10 2.918 10 5.408
2.35 2.01 1.109 1.035 877 1.035 869 1.037

Whg.1 DG

